

The background of the entire page is a dark, out-of-focus bokeh of various colored lights, including white, yellow, orange, red, and green, creating a soft, glowing effect.

**more**than**safety**

# Mobilisation Guide

**Content:**

Standard Uniform	3-37
Engineers Uniform	38-46
Arc Uniform	47-54
Soft Services	55-59
Outerwear & Rainwear	60-69
Hi Visibility Wear	70-76
Footwear	77-83
PPE	84-99
Test Equipment	100-109
LOTO	110-118
Workplace	119-135
Safety Signs	136-144
Tools	145-169

# Standard Uniform



# Poly/Cotton Piqué Polo Shirt

morethansafety

2212296

## Features & Benefits:

- Classic fit
- Taped neck and shoulders
- Half back yoke
- Three self colour button placket
- Cuffed sleeves
- Side vents
- Twin needle stitching
- Superwash® 60°C
- 65% polyester/35% cotton

Size: XS-6XL

Various Available Colours



# Ladies Klassic Poly/Cotton Piqué Polo Shirt

2212282

## Features & Benefits:

- Classic fit
- Taped neck and shoulders
- Half back yoke
- Three self colour button placket
- Cuffed sleeves
- Side vents
- Twin needle stitching
- Superwash 60°C
- 65% polyester/35% cotton

Size: 6-24

Various Available Colours



# Slim Fit Poly/Cotton Piqué Polo Shirt

morethansafety

2219733

## Features & Benefits:

- Classic fit
- Taped neck and shoulders
- Half back yoke
- Three self colour button placket
- Cuffed sleeves
- Side vents
- Twin needle stitching
- Superwash® 60°C
- 65% polyester/35% cotton

Size: XS-6XL

Various Available Colours



# Regular Fit Cooltex Plus Piqué Polo Shirt

2213278

## Features & Benefits:

- Cooltex Plus wicking finish
- 1x1 ribbed knit collar
- Taped neck and shoulders
- Two button slanted placket
- Side vents
- Twin needle stitching
- 100% polyester

Size: XS-5XL

Various Available Colours



# Columbia Performance Polo

2219788

## Features & Benefits:

- Tailored fit, short sleeve
- 3 button placket, 2 side splits
- Suitable for all types of printing, heat transfer and embroidery
- Machine Washable
- 100% Polyester

Size: XS-XXXL

Various Available Colours



**morethansafety**



# Ultimate Poly/Cotton Pique Polo Shirt

2219785

## Features & Benefits:

- Stand up collar
- Two self colour 'raised' stripes on collar and cuffs
- Three horn effect button placket
- Reinforced shoulder seams
- Cuffed sleeves
- Taped side vents

Size: S-XXL

Various Available Colours



# Coolweave Piqué Polo Shirt

2219786

## Features & Benefits:

- Quick dry wicking performance fabric
- Ribbed collar and cuffs
- Taped neck
- Locker patch
- Three self colour button placket
- Panel detail
- Twin needle hem
- Cut out label
- 100% polyester

Size: XS-3XL

Various Available Colours

more**thansafety**



# Hampton Premium Cotton Polo Shirt

2219787

## Features & Benefits:

- Easy care, breathable fabric
- Tailored fit
- Ribbed collar and cuffs
- Three button placket
- Side vents
- Ribbed collar and cuffs
- Twin needle hem
- Suitable for embroidery

Size: S-XXL

Various Available Colours

# Long Sleeve Poly/Cotton Piqué Polo Shirt

2212281

## Features & Benefits:

- 1x1 ribbed flat knit collar
- Narrow three button placket
- Reinforced shoulder seams
- Ribbed cuffs
- Side vents
- Twin needle stitched shoulders, armholes and cuffs
- 65% polyester/35% cotton

Size: XS-XXL

Various Available Colours



## Frederick Premium Cotton Polo

2219789

## Features & Benefits:

- Tailored fit
- Long sleeve, 3 button placket
- Ribbed cuff, 2 side splits
- 95% Cotton, 5% Elastane
- Machine Washable

Size: XS-XXXL

Various Available Colours





# Superior T-Shirt

morethansafety

2216086- Black

2216087- White

## Features & Benefits:

- 1x1 ribbed collar
- Taped neck
- Reinforced shoulder seams
- Twin needle front neck, sleeves and hem
- 100% combed cotton

Size: S-6XL

Various Available Colours



# Ladies Superwash 60°C T-Shirt

2217375- Black

2217376- White

## Features & Benefits:

- Fashion fit
- Ribbed neckline
- Self fabric taped neck and shoulders
- Twin needle sleeves and hem
- Tear out label
- Superwash 60°C
- 65% polyester/35% ringspun combed cotton

Size: 8-18

Various Available Colours





## Fashion Fit Cotton T-Shirt

**2219735**

### Features & Benefits:

- Slim fit
- 1x1 ribbed collar
- Self fabric taped neck and shoulders
- Top-stitched front neck
- Twin needle sleeves and hem
- Tear out label

Size: XS-3XL

4 Available Colours



## Short Sleeve Classic Fit Workwear Oxford Shirt

2211649

### Features & Benefits:

- Easy iron fabric
- Fused, stand up button down collar
- Left chest pocket
- Self colour buttons
- Back yoke with two pleats
- Double stitched side and sleeve seams
- Curved hem
- 50°C wash
- 70% cotton/30% polyester

Size: XS-XXXL

Various Available Colours



## Short Sleeve Classic Fit Workwear Oxford Shirt

2210094

### Features & Benefits:

- Easy iron fabric
- Fused, stand up button down collar
- Left chest pocket
- Self colour buttons
- Back yoke with two pleats
- Double stitched side and sleeve seams
- Curved hem
- 50°C wash
- 70% cotton/30% polyester

Size: XS-XXXL

Various Available Colours



Ladies Short Sleeve Tailored  
Workwear Oxford Shirt



# Ladies Short Sleeve Tailored Workwear Oxford Shirt

2212294

## Features & Benefits:

- Easy iron fabric
- Fused stand up collar
- Self colour buttons
- Front and back darts
- Back yoke
- Curved hem
- 50°C wash
- 70% cotton/30% polyester

Size: XS-3XL

Various Available Colours

more**than**safety



# Ladies Short Sleeve Tailored Workwear Oxford Shirt

2210096

## Features & Benefits:

- Easy iron fabric
- Fused stand up collar
- Self colour buttons
- Front and back darts
- Back yoke
- Curved hem
- 50°C wash
- 70% cotton/30% polyester

Size: XS-3XL

Various Available Colours





# Long Sleeve Classic Fit Workwear Oxford Shirt

morethansafety

2210095

## Features & Benefits:

- Easy iron fabric
- Button down collar
- Left chest pocket
- Self colour buttons
- Back yoke with two pleats
- Double stitched side and sleeve seams
- Adjustable cuffs with button on cuff gauntlet
- Curved hem
- 50°C wash
- 70% cotton/30% polyester

Size: 13.5 - 23 WHITE Available in 14 COLLAR

Various Available Colours



# Short Sleeve Classic Fit Workwear Oxford Shirt

2211648

## Features & Benefits:

- Easy iron fabric
- Button down collar
- Left chest pocket
- Self colour buttons
- Back yoke with two pleats
- Double stitched side and sleeve seams
- Adjustable cuffs with button on cuff gauntlet
- Curved hem, 50°C wash

Size: 13.5 - 23

Various Available Colours



## Ladies Long Sleeve Tailored Workwear Oxford Shirt

2210097

### Features & Benefits:

- Easy iron fabric
- Fused stand up collar
- Self colour buttons
- Front and back darts
- Back yoke
- Double folded seams
- Adjustable cuffs
- Curved hem
- 50°C wash
- 70% cotton/30% polyester

Size- 6-28

Various Available Colours

more**th**ansafety



## Ladies Long Sleeve Tailored Workwear Oxford Shirt

2212278

### Features & Benefits:

- Easy iron fabric
- Fused stand up collar
- Self colour buttons
- Front and back darts
- Back yoke
- Double folded seams
- Adjustable cuffs
- Curved hem, 50°C wash
- 70% cotton/30% polyester

Size- 6-28

Various Available Colours





## Short Sleeve Classic Fit Oxford Shirt

2210104

### Features & Benefits:

- Easy iron fabric
- Fused, stand up button down collar
- Left chest pocket
- Back yoke with centre pleat and hanging loop
- Curved hem
- 85% cotton/15% polyester

Size: 13.5 - 23

Various Available Colours

more**than**safety



## Short Sleeve Classic Fit Workwear Oxford Shirt

2211651

### Features & Benefits:

- Easy iron fabric
- Fused, stand up button down collar
- Left chest pocket
- Back yoke with centre pleat and hanging loop
- Curved hem
- 85% cotton/15% polyester

Size: 13.5 - 23

Various Available Colours



# Ladies Short Sleeve Classic Fit Workwear Oxford Shirt

morethansafety

2212122

## Features & Benefits:

- Easy iron fabric
- Button down collar
- Back yoke
- Front and back darts
- Twin needle stitching
- Curved hem
- 85% cotton/15% polyester

Size- 6-28

Various Available Colours



# Ladies Short Sleeve Classic Fit Workwear Oxford Shirt

2212293

## Features & Benefits:

- Easy iron fabric
- Button down collar
- Back yoke
- Front and back darts
- Twin needle stitching
- Curved hem
- 85% cotton/15% polyester

Size- 6-28

Various Available Colours

# Premium Long Sleeve Classic Fit Oxford Shirt

**2210103**- White

**2211650**-Black

## Features & Benefits:

- Easy iron fabric
- Fused, stand up button down collar
- Back yoke with centre pleat and hanging loop
- Double folded seams
- Adjustable cuffs with button on cuff gauntlet
- Curved hem
- 85% cotton/15% polyester

Size: 13.5 - 23

Various Available Colours

**morethansafety**



# Ladies Long Sleeve Classic Fit Workwear Oxford Shirt

**2212276**- White

**2212277**- Black

## Features & Benefits:

- Easy iron fabric
- Fused stand up collar
- Back yoke
- Double folded seams
- Princess seams
- Three button cuffs
- 85% cotton/15% polyester

Size- 6-28

Various Available Colours



# Toronto Long Sleeve Oxford Shirt

more**than**safety

2219790

## Features & Benefits:

- Tailored fit
- Button down collar, French Placket
- Contrast detailing
- 60% Cotton, 40% Polyester

Size- 14-20"

\*Size 21" and 22" available in White and Sky Blue only

Various Available Colours



# Calgary Royal Oxford Shirt

morethansafety

2219791

## Features & Benefits:

- Tailored fit
- Short sleeve
- Button down collar
- French placket, contrast detailing
- 60% Cotton / 40% Polyester - easy iron

Size: 14-22"

Size 21" and 22" available in White and Sky Blue only

Various Available Colours



# Arundel Cotton Acrylic V Neck Sweater

2210089

## Features & Benefits:

- 12 gauge
- Set in sleeves
- Tubular linked mitred V neck
- 1x1 ribbed cuffs and hem
- 50% cotton/50% acrylic

Size: XS-3XL

3 Available Colours

more**th**ansafety



# Ladies Arundel Cotton Acrylic V Neck Sweater

2210090

## Features & Benefits:

- 12 gauge
- Set in sleeves
- Tubular linked mitred V neck
- 1x1 ribbed cuffs and hem
- 50% cotton/50% acrylic

Size: 6-20

3 Available Colours



# Boston V-neck Jumper

morethansafety

2219794

## Features & Benefits:

- V-neck, long sleeve
- Ribbed neck
- Cuff and hem
- Contrast inner neck strip
- 60% Cotton, 40% Acrylic
- 12 gauge knit

Size- XS-3XL

Various Available Colours



# Sweatshirt

morethansafety

2214193

## Features & Benefits:

- Drop shoulder style
- Self fabric collar
- Taped neck and shoulders
- Double layer self fabric cuffs and hem
- Twin needle stitched shoulders and armholes
- Tear out label
- Superwash® 60°C
- 65% polyester/35% cotton

Size: XS-4XL

3 Available Colours



## Ecologie Unisex Crater Recycled Sweatshirt

2219792

## Features & Benefits:

- Peached finish
- Brushed back fleece
- Relaxed fit
- Drop shoulder style
- Ribbed collar, cuffs and hem
- Unbranded size label
- Recycled cotton is made from 100% pre-consumer waste
- 70% recycled cotton/30% recycled polyester

Size: XS-XXL

3 Available Colours





## Jackson Crew Neck Jumper

2219793

### Features & Benefits:

- Crew neck, long sleeve
- Ribbed neck, cuff and hem
- Contrast inner neck strip
- 60% Cotton, 40% Acrylic
- 12 gauge knit
- Machine Washable

Size: XS-3XL

3 Available Colours



# 1/4 Zip Sweatshirt

2219795

## Features & Benefits:

- Drop shoulder style
- Double layer cadet collar
- Covered zip neck
- Taped neck and shoulders
- Ribbed cuffs and hem
- Tear out label
- 80% cotton/20% polyester

Size: XS-3XL

3 Available Colours

morethansafety



# Unisex Sustainable 1/4 Zip Sweatshirt

2219796

## Features & Benefits:

- Brushed back fleece
- Forward shoulder seams
- Regular fit
- Zip neck with metal zip
- Two inseam front zip pockets
- Side panels
- Ribbed cuffs and hem
- Cut out label
- 60% regenerated cotton/40% recycled polyester

Size: XS-4XL

3 Available Colours



# Dallas 1/4 Zip Jumper

morethansafety

2219797

## Features & Benefits:

- 1/4 zip jumper
- Faux leather zip pull
- Ribbed neck, cuff and hem, contrast
- 60% Cotton, 40% Acrylic
- 12 gauge knit

Size- XS-3XL

3 Available Colours

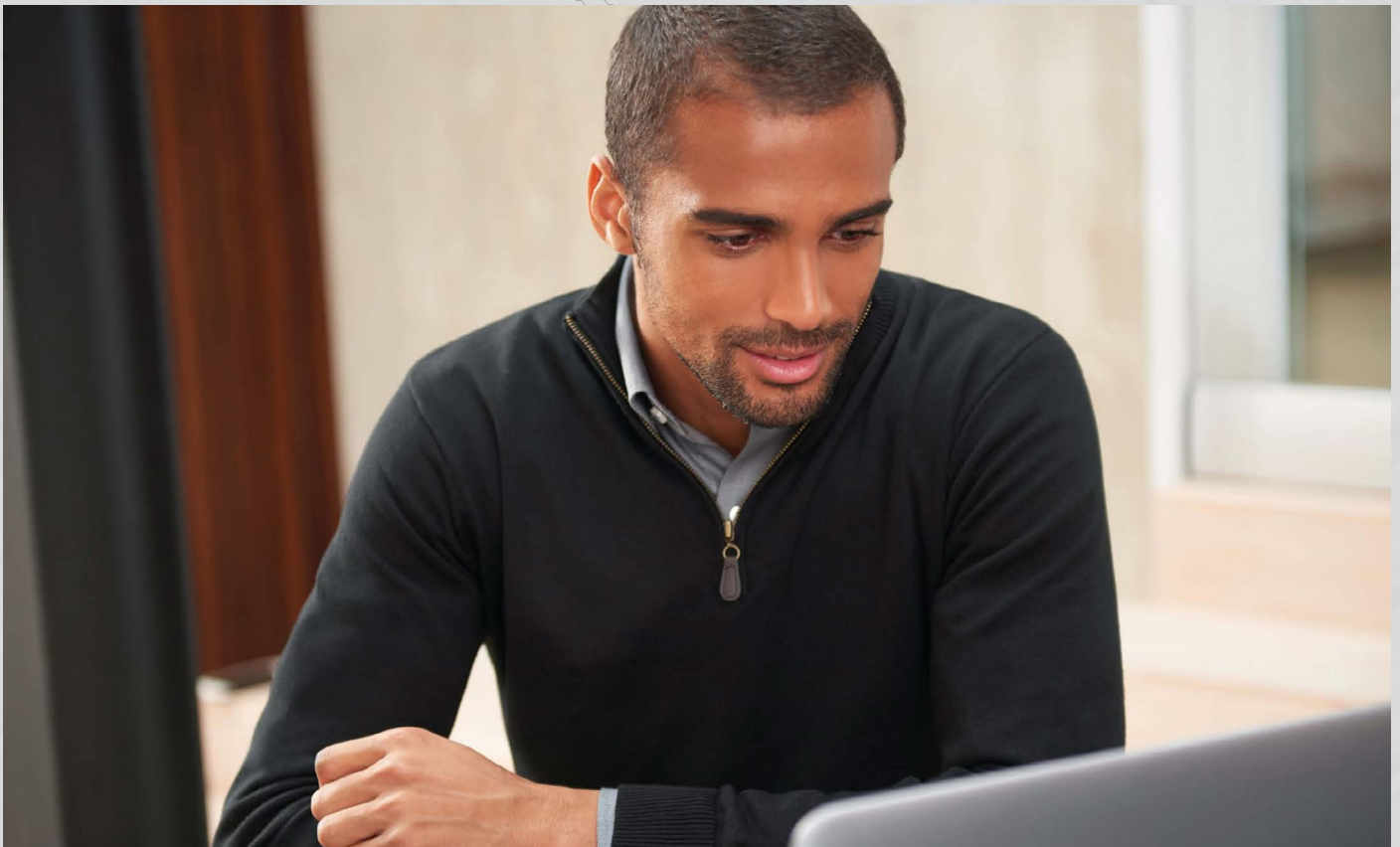

# Honestly Made Recycled Soft Shell Jacket

2219798

## Features & Benefits:

- Warm backed woven recycled polyester outer
- Showerproof and wind resistant
- Quick drying
- Full length low profile zip with chin guard and inner zip guard
- Right chest zip pocket
- Two front zip pockets
- Open cuffs and hem
- Cut out label
- Two layer soft shell

Size: S-3XL

Various Available Colours



morethansafety



# Basecamp Soft Shell Jacket

2219799

## Features & Benefits:

- 96% recycled polyester/4% elastane outer
- Micro fleece backed
- EcoShield DWR finish
- Showerproof and wind resistant
- Full length zip with chin guard and inner zip guard
- Right chest pocket & two front zip pockets
- Bound elasticated cuffs
- Drawcord hem
- Branding on zip pulls and lower side seams

Size: S-3XL

Various Available Colours



# Gannet EarthPro Soft Shell Jacket

morethansafety

2219800

## Features & Benefits:

- Premium quality softshell made from post-consumer recycled polyester
- High performance technical fabric suitable for all seasons
- Lined for increased comfort using recycled material & a Spacious, detachable hood
- Three zipped external pockets, internal mobile pocket and twin pen pocket
- High quality zips made from recycled material
- 92% GRS post-consumer recycled polyester 8% elastane
- Twin needle stitched seams for durability

Size- XS-5XL

2 Available Colours



# Active Hooded Soft Shell Jacket

2219801

## Features & Benefits:

- 94% recycled polyester/6% elastane outer
- AquaDry membrane with EcoShield DWR finish
- Honeycomb micro fleece inner layer
- Showerproof and wind resistant
- Grown on adjustable hood
- Full length zip chin guard and inner zip guard
- Contrast body and underarm panels
- Two front zip pockets
- Tear release adjustable cuffs

Size- XS-3XL

3 Available Colours



# Thor 300 Fleece Jacket

2219802

## Features & Benefits:

- Warm backed woven recycled polyester outer
- Showerproof and wind resistant
- Full length low profile zip with chin guard and inner zip guard
- Right chest zip pocket
- Two front zip pockets
- Open cuffs and hem
- Two layer soft shell
- 100% polyester 300 series anti-pill symmetry fleece
- Quick drying

Size: S-3XL

Various Available Colours



**more**thansafety



# Honestly Made Recycled Fleece Jacket

2219803

## Features & Benefits:

- Easy care and quick drying
- Lightweight
- Unlined
- Taped neck
- Full length zip
- Right chest zip pocket
- Two front zip pockets
- Open cuffs and hem
- 100% recycled anti-pill Symmetry fleece

Size: S-3XL

2 Available Colours



# Corey 200 Micro Fleece Jacket

morethansafety

2219804

## Features & Benefits:

- 100% polyester
- Approximately 40 bottles were recycled to make this product
- A lightweight construction
- Insulating layer offers outstanding warmth and is suitable for a range of activities

Size- S-3XL

Various Available Colours

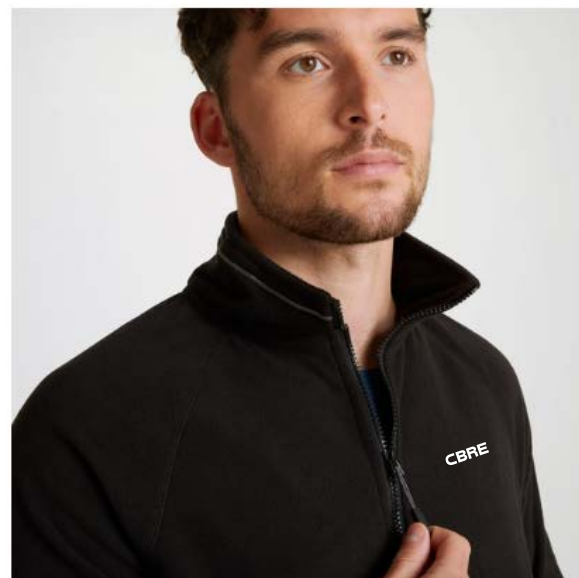

# Kiwi Tailored Trousers

morethansafety

2204058

## Features & Benefits:

- Complete with 9 pockets and belted, part-elasticated waist
- The peached polyester cotton fabric is sun-protective and insect bite-proof with reinforced seat and knee for extra durability

Size- 30-42 S/R/L

Various Available Colours



# Womens Kiwi Trousers

2204065

## Features & Benefits:

- Protective all-seasons trousers with impressive workwear credentials
- The sun-protective polyester cotton construction is insect bite-proof
- EcoShield PFC-free splashproof finish and incorporating 6 useful pockets

Size: 8-20 S/R/L

Various Available Colours



# Mannheim Trouser

morethansafety

2011420

## Features & Benefits:

- Ergonomic fit to suit the shape of your legs with reinforced gusset on the inside of the legs and crotch
- Durable triple stitched seams on leg and crotch extend product life
- Integrated phone pocket in the right pocket
- Top loading durable CORDURA® reinforced adjustable kneepad pockets, with flap so they don't collect dirt
- Extra visibility with the help of reflectors
- Co-certified for use with MASCOT kneepad type SHORT or LONG, as the kneepad pocket is height-adjustable
- 65% polyester/35% cotton

Size- 27-58 S/R/L

Various Available Colours

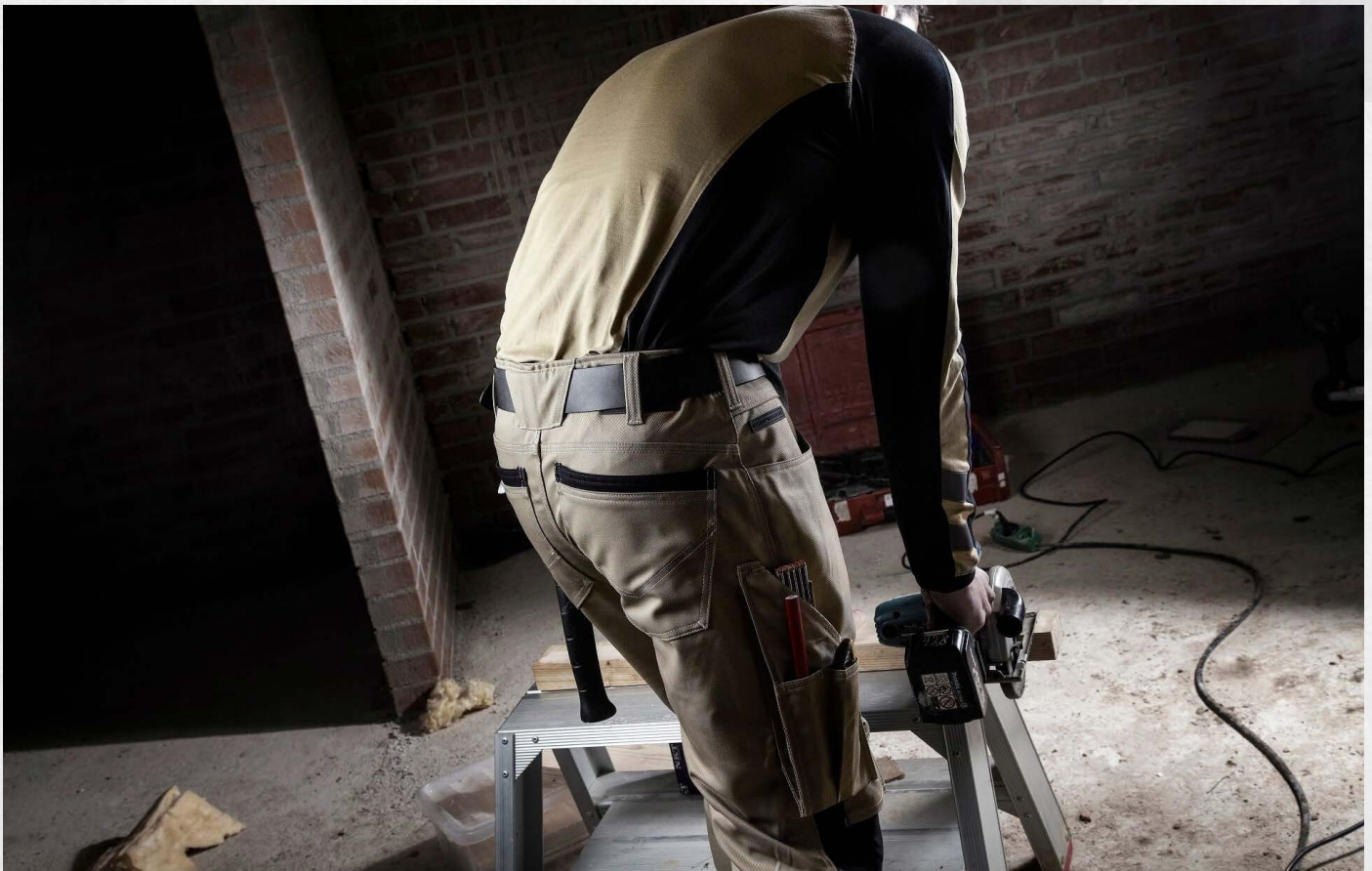

# Unique Diamond Fit Trouser

2012005

## Features & Benefits:

- Diamond fit is especially designed for women with a difference of more than 20 centimetres between their waist and hip measurements
- Durable triple stitched seams on leg and crotch extend product life
- Low waist with form-cut waistband ensures comfort and freedom of movement
- Reinforced back pockets and ruler pocket
- Extra visibility with the help of reflectors
- Light material suited to warm surroundings

Size- UK 6- UK 28

2 Available Colours



morethansafety



# Ripstop Stretch Service Trouser

2204004

## Features & Benefits:

- Stretch panels in crotch, calf and knee pocket
- 60% cotton, 40% polyester, ripstop 250 g/m<sup>2</sup>
- Leg pocket with bellow, pen pocket and inside phone pocket in mesh
- Kneepad pockets – top loaded with flap and velcro closure
- Stretch material both inside and out for a better ergonomic fit
- Ruler pocket with knife holder and pen pocket
- Adjustable leg bottom with buttons
- EN 14404:2004+A1:2010 together with knee protection 4027 and 4057

Size: 8-20 S/R/L

Various Available Colours

## Women's Ripstop Stretch Service Trouser

**morethansafety**

**2204005**

### Features & Benefits:

- The elasticated waist and stretch panels on the calves and inner thighs provide superb mobility
- Scratch free, Stretch panels in crotch, calf and knee pocket
- 60% cotton, 40% polyester, ripstop 250 g/m<sup>2</sup>
- Cordura®-stretch reinforced kneepockets
- Reflective details
- Side hammer loop, Hidden buttons & Elastic at waistline
- EN 14404:2004+A1:2010 together with knee protection 4027 and 4057

Size: XS-4XL

Various Available Colours



## Accelerate Ultimate Stretch Trouser

**2203975**

### Features & Benefits:

- Ultimate stretch material
- The water-repellent multi functional stretch material combines a low weight with a very high durability
- The product tolerates industrial washing
- Excellent ventilation at the knee area via a zipper on the side of the leg
- The kneepad pockets of durable CORDURA are adjustable
- OEKO-TEX® STANDARD 100
- 88% polyester/12% elastolefin

Size: UK 27- UK 58

Various Available Colours

# Accelerate Ultimate Stretch Diamond Fit Trousers

morethansafety

2203976

## Features & Benefits:

- Diamond fit is especially designed for women with a difference of more than 20 centimetres between their waist and hip measurements
- Ultimate stretch material provides unique freedom of movement and high comfort
- The kneepad pockets of durable CORDURA® are adjustable
- The product is covered by OEKO-TEX STANDARD 100
- Has a water-repellent finish
- Double stitched seams on leg and crotch & Low waist

Size- UK 6- UK 28

Various Available Colours



## Base Layer Bottom

2650168

## Features & Benefits:

- 92% recycled polyester/8% elastane
- Finished with added stretch for comfort
- Quick drying and wicking performance fabric
- Designed to be worn next to the skin
- Elasticated waistband
- Feature stitching

Size: S-3XL

Colour: Black



# Short Sleeve Base Layer Top

**morethansafety**

**2650166**

## Features & Benefits:

- 92% recycled polyester/8% elastane
- Finished with added stretch for comfort
- Quick drying and wicking performance fabric
- Designed to be worn next to the skin
- Self fabric collar
- Featured stitching
- Twin needle sleeves and hem

Size: XS-3XL

Colour: Black



# Long Sleeve Base Layer Top

**2650167**

## Features & Benefits:

- 92% recycled polyester/8% elastane
- Finished with added stretch for comfort
- Quick drying and wicking performance fabric
- Designed to be worn next to the skin
- Self fabric collar
- Featured stitching
- Twin needle sleeves and hem

Size: XS-3XL

Colour: Black



# Engineers Uniform



# B&C MY POLO 180

morethansafety

2219973

## Features & Benefits:

- Classic modern style – easy to wear
- High-density fine piqué delivers a soft hand feel and outstanding printability
- Crafted in high-quality fabric
- Shoulder seam with reinforcement tape and comfortable neck tape
- Certified OEKO-TEX® and Peta-approved Vegan

Size: S-5XL

Various Available Colours



## My Polo 180 Cotton Womens

2219974

## Features & Benefits:

- Classic modern style – easy to wear
- Contemporary two-button reinforced placket
- Certified OEKO-TEX® and Peta-approved Vegan
- Ringspun fabric ensures a long-lasting garment with extra-soft hand feel

Size: XS-3XL

Various Available Colours



# Long Sleeve Cotton Pique Polo Shirt

morethansafety

2219282

## Features & Benefits:

- 100% cotton
- Stand up collar
- Three button placket with horn effect buttons
- 1x1 ribbed narrow cuffs
- Side vents
- Twin needle stitching

Size: S-XXL

Various Available Colours



# Crossover Long Sleeve T-Shirt

2217926

## Features & Benefits:

- Modern, close fit with great freedom of movement
- Combed cotton absorbs moisture and is extra comfortable against the skin
- Ribbed collar and sleeves
- Extra padding over the seam at the neck so the seam does not cause irritation
- OEKO-TEX® STANDARD 100

Size: XS-4XL

Various Available Colours





# Multisafe Long Sleeve T-Shirt

**morethansafety**

**2217927**

## Features & Benefits:

- Great protection with anti-static and flame-retardant properties
- Modern, close fit with great freedom of movement
- Ribbed neck
- Extra padding over the seam at the neck so the seam does not cause irritation
- 60% modacrylic/39% cotton/1% carbon fibres
- Long life, with flame retardant thread used in seams

Size: S-4XL

Various Available Colours



# 100% Cotton Sweatshirt

**2218278**

## Features & Benefits:

- High quality, premium weight sweatshirt
- Elasticated cuffs, neckline and waistband
- Brushed fleece inner
- Padded, taped neckline for comfort
- Half moon yoke at neck
- Set in sleeve styling
- Ideal for corporate logos
- Very comfortable to wear
- Triple stitched on all main seams for ultimate strength
- 100% Cotton

Size: XS-5XL

Various Available Colours



# My Polo 180 Cotton Long Sleeve

2219975

## Features & Benefits:

- Timeless, classic modern style
- Shoulder seam with reinforcement tape and comfortable neck tape
- Crafted in high-quality fabric
- Authentic polo feature: superior 1x1 rib cuff, with dimensionally-stable elastane
- Ring-spun fabric ensures a long-lasting garment

Size: S-5XL

Various Available Colours



# 100% Cotton Industry Jacket

2219272

## Features & Benefits:

- 100% cotton, twill, 320 g/m<sup>2</sup>
- Chest pockets with bellow and flap, one with two-compartment pen pocket
- Shoulder sections in contrasting colour
- Bellow on back
- Removable ID pocket
- Hidden one-way plastic zipper
- Adjustable sleeve end

Size: XS-5XL

2 Available Colours



# 100% Cotton Industry Trouser

morethansafety

## 2204002

The 1404 two-tone industry trousers are comfortable, sturdy and hard wearing. Durable material, good fit and modern design make this trouser the ultimate first choice for those working in industry.

### Features & Benefits:

- 100% cotton, twill, 320 g/m<sup>2</sup>
- Plastic zipper fly
- Wide loops at back and sides
- Removable ID pocket
- Back pockets with flap
- Leg pocket with telephone pocket, ID pocket and pen pockets
- Retains its shape for additional comfort

Size: 30-47 Different Lengths available.

2 Available Colours



# CAT Charge Hiker Boot

morethansafety

**8011932**

The Charge S3 is a non-metallic safety hiker with a composite toe and an SRC rated slip resistant rubber outsole.

## Features & Benefits:

- Fully Non-Metal Water Resistant ESD Safety Trainer
- Energy Absorbent Heel
- Fuel & Oil Resistant Outsole
- Antistatic
- Heat Resistant outsole to 300 Degrees
- Resistance to high heat
- Toe Protection
- Midsole~Antistatic~Water Resistant
- Heel energy absorption~Electro Static Dissipative~Composite cap~Composite midsole~Slip resistant

Size: 3-13

2 Available Colours



# CAT Charge Trainer Shoe

**8011933**

The Charge S3 is a non-metallic safety trainer with a composite toe and an SRC rated slip resistant rubber outsole.

## Features & Benefits:

- Fully Non-Metal Water Resistant ESD Safety Trainer
- Energy Absorbent Heel
- Fuel & Oil Resistant Outsole
- Antistatic
- Heat Resistant outsole to 300 Degrees
- Resistance to high heat
- Toe Protection
- Midsole~Antistatic~Water Resistant
- Heel energy absorption~Electro Static Dissipative~Composite cap~Composite midsole~Slip resistant

Size: 3-13



**8011836**

Ultra-slip resistant sole. Excellent traction with ultra-slip resistant soles. Approved by both SRA (tested with soap on ceramics) and SRB (tested with glycerol on steel), which automatically achieves the best standard for slip-resistant soles SRC.

## Features & Benefits:

- The weight of the footwear is among the lowest on the market
- Elastic uppers of durable textile almost feel like an extra sock – they fit close and flexibly to the foot and deliver high comfort
- Removable insole with optimal arch support that can counteract the tendency to flat foot
- The front part of the shoe bends flexibly with the foot
- The composite toecap is completely free of metal. The composite material does not conduct heat or cold, so the composite toecap provides extra comfort in both hot and cold surroundings
- ETPU insert in the entire sole absorbs shock effectively, so the back and legs are protected with every step
- Shock-absorbing, soft and flexible two-component sole of PU/PU
- ESD Approved to DIN EN 61340-4-3: 2002 + DIN EN 61340-5-1: 2008
- Category: S1P SRC Standard: EN ISO 20345 2011

ESD Approved to DIN EN 61340-4-3: 2002 + DIN EN 61340-5-1: 2008. Footwear with an ESD label avoid electrostatic charging and are able to conduct away controlled static electricity from the body. This will avoid damages to, for example, sensitive electronic components.

Size: 6-13



8011838

Ultra-slip resistant sole. Excellent traction with ultra-slip resistant soles. Approved by both SRA (tested with soap on ceramics) and SRB (tested with glycerol on steel), which automatically achieves the best standard for slip-resistant soles SRC.

## Features & Benefits:

- The weight of the footwear is among the lowest on the market
- Elastic uppers of durable textile almost feel like an extra sock – they fit close and flexibly to the foot and deliver high comfort
- Removable insole with optimal arch support that can counteract the tendency to flat foot
- The front part of the shoe bends flexibly with the foot
- The composite toecap is completely free of metal. The composite material does not conduct heat or cold, so the composite toecap provides extra comfort in both hot and cold surroundings
- ETPU insert in the entire sole absorbs shock effectively, so the back and legs are protected with every step
- Shock-absorbing, soft and flexible two-component sole of PU/PU
- ESD Approved to DIN EN 61340-4-3: 2002 + DIN EN 61340-5-1: 2008
- Category: S1P SRC Standard: EN ISO 20345 2011

ESD Approved to DIN EN 61340-4-3: 2002 + DIN EN 61340-5-1: 2008. Footwear with an ESD label avoid electrostatic charging and are able to conduct away controlled static electricity from the body. This will avoid damages to, for example, sensitive electronic components.

Size: 3-13



# Arc Uniform



MTS CODE	DESCRIPTION	Basic Cotton / FR	Level 1 Arc	Level 2 Arc	Level 3 Arc	Optional
<b>UNDER GARMENTS</b>	✓* You do not need to buy these underwear items specifically, it's a suggestion, however the minimum standard of 100% cotton or FR underwear is a mandatory requirement.					
2801089	ProGARM FR Mens Boxer Briefs	✓*	✓*	✓*	✓*	
2801103	ProGARM FR Womens Boxer Briefs	✓*	✓*	✓*	✓*	
2601320	ProGARM FR Bra	✓*	✓*	✓*	✓*	
2801090	ProGARM FR Socks	✓*	✓*	✓*	✓*	
2801087	ProGARM Baselayer Top					✓
2801088	ProGARM Baselayer Leggings					✓

PPE	DESCRIPTION	Basic Cotton / FR	Level 1 Arc	Level 2 Arc	Level 3 Arc	Optional
	✓** Multiple options available, only one item of each product type needed.					
1301136	Clear Lens Safety Spectacles	✓	✓	✓	✓	
1201300	TPR Disposable Ear Plugs	✓	✓	✓	✓	
1010621	ProGARM 2700 Arc Gloves	✓	✓	✓		
1010624	ProGARM 2678 Arc Gloves				✓	✓
2800108	Hi-Vis Anti-Static Flame Retardant Waistcoat	✓	✓	✓	✓	
1751941	ProGARM Balaclava	✓	✓	✓	✓	
1751943	ProGARM Snood					✓
8011842	Ultrar Safety Shoe	✓**	✓**			
8011761	Trivor Safety Boot	✓**	✓**			
8011838	Energy Safety Shoe	✓**	✓**			
8011836	Energy Safety Boot	✓**	✓**			
1751237	Electrical Arc Boot			✓	✓	
1103335	ProGARM 2696 36 CAL Arc Flash Safety Helmet			✓	✓**	
1751942	ProGARM 9700 Arc 4 Hood, 47cal				✓**	
1700160	ProGARM FR Kneepads					✓
2601319	ProGARM Belt					✓

CLOTHING	DESCRIPTION	Basic Cotton / FR	Level 1 Arc	Level 2 Arc	Level 3 Arc	Optional
	✓** Multiple options available, only one item of each product type needed.					
2801079	ProGARM 5280 Polo Shirt	✓**	✓			
2801082	ProGARM 5200 Polo Shirt			✓	✓	
2203912	MASCOT® CROSSOVER Long Sleeved T-shirt	✓**				
2203198	MASCOT® MULTISAFE Long-sleeved T-shirt	✓**				
2200286	100% Cotton Longsleeve Polo Shirt	✓**				
2203718	100% Cotton Longsleeve Polo Shirt	✓**				
2900109	100% Cotton Sweatshirt	✓				
2801086	ProGARM 5630 Sweatshirt					✓
2204003	Industry Jacket	✓				
2204002	Industry Trousers	✓				
2801080	ProGARM 7638 Trouser		✓**	✓**	✓	
2801081	ProGARM 7720 Combat Trouser		✓**	✓**		
2801083	ProGARM 5850 Jacket			✓		
2801084	ProGARM 6458 Coverall			✓	✓	
2801085	ProGARM 9931 Softshell				✓	
2601318	ProGARM Detachable Holster Pocket					✓



# Arc Polo Shirt

morethansafety

2801091

## Features & Benefits:

- Enclosed stud placket ~ Allows quick fastening
- VXS+ Flame Resistant blend ~ Natural feel, Comfortable & Soft
- Breathable with moisture management
- ThermSAFE plastic FR poppers, CE Certified
- Knitted collar with tipping
- Rib knit cuffs ~ Close fit
- SafetyICON™ on arm ~ Visual EN Standards icon system

EN Standard: EN 1149 // IEC 61482

Colour: Navy

Size S-4XL

Suitable for:



# Arc Polo Shirt

2801092

## Features & Benefits:

- Arc Flash protection and Flame Resistant fabric
- Enclosed stud placket ~ Allows quick fastening
- VXS + blend a natural feel, comfortable & soft
- Breathable with moisture management
- ThermSAFE plastic FR poppers, CE Certified
- Knitted collar with tipping
- Rib knit cuffs ~ Close fit

EN 1149-5:2008: Pt. 5:2008 // Pt. 3:2004 //

Charge Decay

EN ISO 11612:2015: A1 // B1 // C1 // F1

Colour: Navy

Size S-4XL

Suitable for:



# Workwear Trouser

morethansafety

2801080

## Features & Benefits:

- Arc Flash protection and Flame Resistant fabric
- Kneepad pockets, Wear with kneepads for extra comfort
- Mobile phone pocket ~ Keep your phone safe
- Extra wide belt loop at rear ~ Prevents belt riding up
- ThermSAFE plastic Flame Resistant zipper CE Certified
- Triple stitched side seams ~ Lifetime quality assurance
- Reinforced crotch improved longevity
- ThermSAFE Jeans button Jeans style fastening

EN Standard: EN 1149 // IEC 61482

Colour: Navy

Size: 30-52 R/L/S

Suitable for:

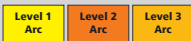

# Combat Trouser

2801081

## Features & Benefits:

- External kneepad pockets
- Extra wide belt loop at rear
- ThermSAFE plastic FR Zipper CE Certified
- SafetyICON on leg pocket ~ Visual EN Norm icon system
- Reinforced crotch, Improved longevity
- Reinforced long hem ~ Stronger leg hem ~ ability to extend / shorten leg
- ThermSAFE™ Jeans button

EN Standard: EN 1149 // IEC 61482

Colour: Navy

30-52 R/L/S

Suitable for:



# Arc Jacket

2801095

## Features & Benefits:

- Mandarin collar ~ Maximum neck protection
- Gas monitor loop ~ Secure fixing point
- SafetyICON on arm ~ Visual EN Standards icon
- 5cm Flame Resistant Anti Static Reflective Tape ~Double stitched for longer life
- Cuff tabs with velcro Brand fasteners
- ThermSAFE plastic flame resistant zipper
- Extended back ~ Protection when bending over
- Triple stitched side seams
- Easy-Stretch side panels
- Adjustable waist straps

EN Standard: EN 1149 // IEC 61482

Colour: Navy  
Size S-4XL

Suitable for: 



# Softshell Jacket

2801094

## Features & Benefits:

- Mandarin collar ~ Maximum neck protection
- Velcro brand fasteners on cuffs and back
- Radio loop attaching point on left breast
- Microfleece lining for warmth and comfort
- Easy Stretch side panels ~ Wear comfort
- Extended back ~ Protection when bending over
- ThermSAFE plastic FR Zipper ~ CE Certified
- ThermSAFE™ two-way plastic FR Zipper

EN Standard: EN 1149 // IEC 61482

Colour: Navy  
Size S-4XL

Suitable for: 



# Hi Vis Coverall

morethansafety

2801096

## Features & Benefits:

- Flame Resistant fabric and Arc Flash protection
- Mandarin collar ~ Maximum neck protection
- Kneepad pockets
- Vertical zip chest pockets ~ Accessible when wearing a harness
- Expandable ankle opening with zippers
- SafetyICON on arm ~ Visual EN Standards icon system
- 5cm Heat Applied Reflective Tape
- Combat pocket on leg plus sleeve pocket Cuff tabs with VELCRO brand fasteners
- ThermSAFE plastic FR zippers ~ CE Certified
- Internal elastic two-point adjustable waistband ensures close fit
- Triple stitched side seams
- Easy-Stretch side panels

EN Standard: EN 1149 // IEC 61482

Colour: Navy/Hi Vis Yellow  
Size S-4XL

Suitable for:

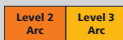

# Arc Coverall

2219200

## Features & Benefits:

- Mandarin collar, Maximum neck protection
- Kneepad pockets
- Gas monitor loop
- SafetyICON™ on arm ~ Visual EN Norm icon system
- 5cm FR AS Reflective Tape ~ Double stitched for longer life
- Cuff tabs with VELCRO
- Side access pockets ~ With entry inside coverall
- ThermSAFE plastic FR Zippers ~ CE Certified
- Internal elastic 2 Point adjustable waistband

EN Standard: EN 1149 // IEC 61482

Colour: Navy  
Size S-4XL

Suitable for:



# Electrical Safety Boot

morethansafety

1751237

EN ISO 20345:2011



## Features & Benefits:

- External Lining: breathable
- Upper: water repellent full-grain leather
- Internal lining: Sany-dry 100% polyester fabric, three-dimensional ~ breathable ~ antibacterial ~ it absorbs and releases the moisture ~ abrasion-resistant
- Footbed: Heat barrier, made of soft and scented polyurethane, anatomic, insulating against high temperatures ~ covered with cloth
- Sole: Heat defender PU/nitrile rubber resistant to +300 °C (1 minute contact)
- Toe cap: non metallic TOP RETURN resistant to 200 J
- Midsole: non metallic APT PLATE - Zero Perforation with high electrical resistance
- Width: 10 Mondopoint (size 39/6) - 11 Mondopoint
- Performances & technical features: 100% Metal Free, Anti-torsion Support, Cold Protection (CI), Heat Resistant (HI), HRO

Size: 40-48/6,5-13

# Soft Services



# Piqué Polo Shirt

morethansafety

2218072

## Features & Benefits:

- Ribbed collar
- Taped neck
- Three self colour button placket
- Twin needle stitching
- 60°C wash
- 50% polyester/50% cotton

Size XS-8XL



# Polyester Polo Shirt

2218043

## Features & Benefits:

- Spun polyester piqué knit
- Soft cotton feel fabric
- Modern fit
- Ribbed collar & Taped neck
- Three self colour button placket
- Spare button
- Twin needle stitching

Size S-3XL



# Ultra Cotton T-Shirt

morethansafety

2218044

## Features & Benefits:

- Classic fit
- Ribbed collar
- Taped neck and shoulders
- Twin needle sleeves and hem
- Tubular body
- Tear out label (some colours in transition)
- Material: 100% cotton

Size: S-5XL

Various Available Colours



# Crew Neck Sweatshirt

2216895

## Features & Benefits:

- Drop shoulder style
- Modern and comfortable fit
- Ribbed collar, cuffs and hem
- Taped neck
- Twin needle stitching
- 55% polyester/45% cotton

Size: S-7XL

Various Available Colours





# Acrylic V Neck Sweater

more**than**safety

2218071

## Features & Benefits:

- 12 gauge
- Fine knit
- Easy care
- Set in sleeves
- Soft feel and contemporary styling
- Ribbed knit neck, cuffs and hem

Size S-5XL

2 Available Colours



# Cargo Trouser

**morethansafety**

**2202348**

## Features & Benefits:

- 65% Polyester 35% Cotton
- Flat front with sewn-in front crease
- 2 side & 2 rear pockets with velcro flaps
- 2 thigh pockets with velcro flaps
- Metal rivet button fastening at waist
- Twin belt loops reinforced for extra strength
- Washable at 60 Degrees

Size 28-52 (S/R/L)

2 Available Colours



# Ladies Cargo Trousers

**2202347**

## Features & Benefits:

- 65% Polyester 35% Cotton
- Fabric: 245 GSM/7 oz
- Single belt loops reinforced for extra strength
- Metal Button at waist
- 2 side & 2 rear pockets with velcro flaps
- 2 thigh pockets with velcro flaps
- Flat front
- Wide belt loops

Size 8-20 (R)

2 Available Colours



# Outerwear & Rainwear



# Diamond Quilted Bodywarmer

morethansafety

2214969

## Features & Benefits:

- Polyester taffeta lining
- Thermo-Guard insulation
- Shower proof and wind resistant
- Collar high full length zip with studded storm flap
- Back vents with stud closure
- Quilted micro poplin polyester
- Access for decoration

Size S-3XL

2 Available Colours



# Women's Diamond Quilted Bodywarmer

2214968

## Features & Benefits:

- Polyester taffeta lining
- Thermo-Guard insulation
- Shower proof and wind resistant
- Collar high full length zip with studded storm flap
- Back vents with stud closure
- Quilted micro poplin polyester
- Access for decoration

Size 8-20

2 Available Colours



# Wave Bodywarmer

morethansafety

2214970

## Features & Benefits:

- Polyester padding
- Contrast nylon lining
- Shower proof
- Polyamide 380T outer
- Collar high full length contrast zip
- Two contrast front zip pockets
- Self fabric binding on hem

Size: S-3XL



# Ladies Wave Bodywarmer

2214971

## Features & Benefits:

- Polyester padding
- Contrast nylon lining
- Shower proof
- Polyamide 380T outer
- Collar high full length contrast zip
- Two contrast front zip pockets
- Self fabric binding on hem

Size: S-3XL



# Thinsulate Woolly Hat

morethansafety

2217487

## Features & Benefits:

- 3M™ Thinsulate™ insulation
- 3M™ label sewn on turn up
- Scotchguard™ rainproof coated yarns
- Double thickness
- 100% soft touch acrylic

One Size



## Original Cuffed Beanie

2211763

## Features & Benefits:

- Double layer knit
- Cuffed design
- 100% soft touch acrylic

One Size



morethan**safety**



Thinsulate | Woolly Hat

# Beauford Waterproof Insulated Jacket

morethansafety

2218578

## Features & Benefits:

- Polyester lining/Hydrafort 5000 peached polyester outer
- Thermo-Guard® insulation
- Waterproof with taped seams
- Windproof
- Unlined, concealed adjustable hood
- Collar high full length zip with tear release storm flap
- Two front zip pockets with storm flaps
- Adjustable draw cord hem

Size S-3XL



# Packaway Waterproof Breathable Jacket

2219081

## Features & Benefits:

- Waterproof with taped seams
- Windproof and breathable
- Integral adjustable hood
- Full length low profile zip with chin guard and inner zip guard
- Elasticated cuffs
- Packs away into stuff sack

Size XS-3XL





# Ladies Beauford Waterproof Insulated Jacket

more**th**ansafety

2218959

## Features & Benefits:

- Polyester lining, Hydrafort 5000 peached polyester outer
- Thermo-Guard insulation
- Waterproof with taped seams
- Windproof, Shaped fit
- Unlined, concealed adjustable hood
- Collar high full length zip with tear release storm flap
- Two front zip pockets with storm flaps
- Adjustable draw cord hem
- Zip access for decoration

Size 10-20



# Thermic Insulated Jacket

2219805

## Features & Benefits:

- Recycled polyester lux lining
- Recycled polyester hollowfibre padding
- Aqua Dry membrane with EcoShield DWR finish
- Waterproof 10000mm with taped seams
- Breathable 10000g
- Full length waterproof zip with chin guard
- Tear release adjustable cuffs
- Draw cord hem

Size XS- 3XL



# Dover Waterproof Insulated Jacket

morethansafety

2218930

## Features & Benefits:

- 210 series anti-pill Symmetry fleece lining
- Polyamide sleeve lining
- Thermo-Guard insulation
- Waterproof with taped seams & Windproof
- Fleece lined collar
- Concealed adjustable lined hood
- Collar high full length zip with tear release storm flap
- Hydrafort 5000 polyester outer
- Zip access for decoration

Size XXS-5XL



# ECO Dover Waterproof Jacket

2218577

## Features & Benefits:

- Concealed hood with adjusters
- Storm flap with hook and loop
- Adjustable cuffs
- 220 series anti-pill Symmetry fleece lined body
- Waterproof Hydrafort polyester fabric
- Concealed zip entrance in lining for embroidery access

Sizes XS-4XL



**ECO Dover Waterproof  
Insulated Jacket**

**morethansafety**



## Packaway Waterproof Breathable Overtrousers

**2204067**

### Features & Benefits:

- Waterproof with taped seams
- Windproof and breathable
- Elasticated waistband
- Two side pocket openings
- Open leg ends with stud adjusters
- Packs away into stuff sack

Size XS-3XL



## PW3 Rain Trouser

**2100485**

### Features & Benefits:

- Water resistant eco-conscious fabric finish, water beads away from fabric surface
- Easy access cargo pockets
- Side zip leg opening for easy access
- Ergonomically shaped hem
- Waterproof with taped seams preventing water penetration
- 8 pockets for ample storage
- Large back zip pocket for multiple storage options
- 100% Polyester 300D Oxford, Stain Resistant Finish, Double PU Coated:CE certified

Size XS-4XL



## Kiwi Waterproof Trouser

**2204068**

### Features & Benefits:

- Wind Resistant
- Breathable
- Waterproof
- AQUADRY: Guaranteed waterproof and breathable fabric. Designed for moderate to heavy downpours
- Insulating

Size 30-42 (R)



# Hi Visibility Wear



# Hi Vis Vest

morethansafety

2211645

## Features & Benefits:

- 100% polyester
- Hook and loop fastening
- Retro-reflective tape
- 2 x body bands
- 2 x braces
- EN ISO 20471
- Class 2 high visibility

Size S-3XL



# Ladies Hi-Vis Vest

2213484

## Features & Benefits:

- Two reflective bands around the body
- Princess panelling with fitted waist
- Tear release closure
- Tear out label

Size XXS-2XL

3 Available Colours



## Executive Hi Vis Vest

morethansafety

2212295

### Features & Benefits:

- Front zip fastener
- Pen pocket with D ring
- Retromax reflective tape
- 100% Knitted polyester
- ISO 20471 CLASS
- 2\* (Conforms to Class 1 in size XS)
- Large area for printing/badging on front & rear
- Mobile phone pocket with hook and loop fastened flap

Size XS-6XL



## Hi-Vis Winter Traffic Jacket

2217854

### Features & Benefits:

- Waterproof with taped seams preventing water penetration
- Fully lined and padded to trap the heat and increase warmth
- Human shape at a distance
- Pack away hood for added functionality
- Certified to EN ISO 20471 after 50x washes
- 100% Polyester, 300D Oxford, Stain Resistant Finish
- EN ISO 20471 Class 2, EN 343 Class 3 Water Penetration Class 1 Air Permeability

Size XS-6XL  
2 Available Colours



# Evolution HV Storm Coat

morethansafety

2219807

## Features & Benefits:

- Thermally applied RFX Reflective Tape with segmented
- Comfort trim shoulder braces
- PULSAR reflective blue piping and chevron detail
- YKK 2-way zip concealed by double velcro storm flap
- Neoprene inner cuff, underarm ventilation and chin guard
- Two internal A4 sized poachers pockets
- Suitable for use in the automotive industry (car safe)
- EN ISO 20471 Class 3 & EN343 Class 4:3
- Highly breathable 3 layer laminate technology

Size XS-6XL



# Hi-Vis Winter Bomber Jacket

2218579

## Features & Benefits:

- Waterproof with taped seams preventing water penetration
- Extremely water resistant eco-conscious fabric finish
- EN342 Protection against cold certified up to -40°C
- Fleece lined collar to trap the heat and increase warmth
- Certified to EN ISO 20471 after 50x washes
- Hook and loop cuffs for a secure fit
- 100% Polyester

Size XXS-8XL  
3 Available Colours





# Hi Visibility Executive Jacket

2218929

## Features & Benefits:

- Conforms to EN ISO 20471: 2013 + A1: 2016 class 3
- EN343: 2003 + A1: 2007 class 3.3
- Waterproof with taped seams
- Windproof and breathable
- Two reflective bands around the body, sleeves & over each shoulder
- Heavy duty two way zip with tear release storm flap
- Part elasticated waist
- Two angled front pockets with tear release flaps and reflective piping

Size XS-2XL

2 Available Colours

morethansafety



# Hi-Vis Winter Jacket

2219806

## Features & Benefits:

- Premium waterproof and breathable fabric with mechanical stretch
- Extremely water resistant eco-conscious fabric finish
- Fleece lined collar to trap the heat and increase warmth
- 100% Polyester Stretch, 150D, PU Membrane 160g
- EN ISO 20471 Class 3
- Waterproof and breathable with taped seams to prevent water penetration
- Pack away detachable hood for convenience

Size S-4XL

2 Available Colours



# Evolution HV Bomber Jacket

morethansafety

2219808

## Features & Benefits:

- Thermally applied RFX Reflective Tape
- PULSAR reflective blue piping and chevron detail
- YKK 2-way zip concealed by storm flap with a zipped pocket
- Neoprene inner cuff, underarm ventilation and chin guard
- Breathable EVOTECH 3 layer polyester laminate
- Two internal A4 sized poachers pockets & Pen Pocket
- Highly breathable 3 layer laminate technology
- EN ISO 20471 Class 3 & RIS-3279 (Rail Standard)

Size S-7XL



## Hi Visibility Breathable Rain Trousers

2501415

## Features & Benefits:

- Extremely water resistant eco-conscious fabric finish
- ( Certified to EN ISO 20471 ) after 50x washes
- Durable, breathable, windproof and water resistant fabric
- 100% Polyester 300D Oxford, Stain Resistant Finish
- Reflective tape for increased visibility
- Zipped ankles for easy fitting over work boots
- Waterproof with taped seams preventing water penetration

Size S-XXL



# PW3 Hi Vis Extreme Rain Trouser

morethansafety

2501416

## Features & Benefits:

- Waterproof and breathable with taped seams
- Premium stain resistant finish repels oil, water and grime
- Highly breathable 3 layer laminate technology
- Durable, breathable, windproof and water resistant fabric
- Lightweight flexible HiVisTex Pro segmented reflective
- Tape for increased visibility
- Elevated padded back panel keeping the lower back warm
- 100% Polyester, 300D Stretch Oxford, stain resistant finish
- EN ISO 20471 Class 2

Size S-XXL



## Evolution HV Over Trouser

2501417

## Features & Benefits:

- Thermally applied RFX Reflective Tape with segmented comfort trim thigh band for improved abrasion resistance
- PULSAR reflective blue piping and chevron detail
- Highly breathable 3 layer laminate technology (EN ISO 20471 Class 2)
- Fully elasticated waistband with draw cord for a more secure fit
- Combat style thigh pocket to each leg
- Suitable for use in the automotive industry (car safe)

Size XXS-6XL



more**than**safety

# Footwear



# Base Matar Boot

8011915

morethansafety

UNI EN ISO 20345:2012 S3 ESD SRC



## Features & Benefits:

- Anti-static footwear
- Water resistant upper to prevent water penetration
- Non-magnetic - nickel and ferrous free
- 200 joules resistant toe-cap
- Puncture resistant sole
- Shock absorption in the heel region
- Hydrocarbons resistant
- Electronic devices protection from electrostatic discharges
- Orthopaedic made to measure footbed, complying with European norms DGV112-191 Heat Resistant (HI), HRO

Size: 36 - 48

# Base Matar Shoe

8011914

morethansafety

UNI EN ISO 20345:2012 S3 ESD SRC



## Features & Benefits:

- Anti-static footwear
- Water resistant upper to prevent water penetration
- Non-magnetic - nickel and ferrous free
- 200 joules resistant toe-cap, Puncture resistant sole
- Shock absorption in the heel region
- Hydrocarbons resistant
- Electronic devices protection from electrostatic discharges
- Orthopaedic made to measure footbed, complying with European norms DGVII12-191

Size: 6-13

# CAT Charge Hiker Boot

8011853

morethansafety

UNI EN ISO 20345:2012 S3 ESD SRC



## Features & Benefits:

The Charge S3 is a non-metallic safety hiker with a composite toe and an SRC rated slip resistant rubber outsole.

- Composite fiber glass toe protects against impact and compression of 200 joules
- Fully Non-Metal Water Resistant ESD Safety Hiker
- Energy Absorbent Heel
- Fuel & Oil Resistant Outsole
- Anti penetration non-metallic midsole
- Heat Resistant outsole to 300 Degrees
- Antistatic

Size: 6-13

# CAT Charge Trainer Shoe

8011933

morethansafety

UNI EN ISO 20345:2012 S3 ESD SRC



## Features & Benefits:

The Charge S3 is a non-metallic safety trainer with a composite toe and an SRC rated slip resistant rubber outsole.

- Fully Non-Metal Water Resistant ESD Safety Trainer
- Energy Absorbent Heel
- Fuel & Oil Resistant Outsole
- Heat Resistant outsole to 300 Degrees
- Water Resistant with a standard Fit
- Antistatic

Size: 6-13





# Energy Boot S3

8011852

morethansafety

UNI EN ISO 20345:2012 S3 ESD SRC



## Features & Benefits:

- The flexible and light MASCOLAYER textile nail protection
- The composite toecap is completely free of metal
- Removable insole with optimal arch support that can counteract the tendency to flat foot
- Insert in the mid sole of shock-absorbing lightweight material
- Shock-absorbing, soft and flexible two-component sole of PU/PU
- Electronic devices protection from electrostatic discharges
- Orthopaedic made to measure foot bed, complying with European norms DGUV112-191
- Heat Resistant (HI), HRO & ESD Approved
- Hydrocarbons resistant

Size: 6-13

# Energy Shoe S3

8011853

morethansafety

UNI EN ISO 20345:2012 S3 ESD SRC



## Features & Benefits:

- The flexible and light MASCOLAYER textile nail protection
- The composite toecap is completely free of metal
- Removable insole with optimal arch support that can counteract the tendency to flat foot
- Insert in the mid-sole of shock-absorbing lightweight material
- Shock-absorbing, soft and flexible two-component sole of PU/PU
- Electronic devices protection from electrostatic discharges
- Orthopaedic made to measure foot bed, complying with European norms DGUV112-191
- Heat Resistant (HI), HRO
- ESD Approved
- Hydrocarbons resistant

Size: 6-13

# PPE



# CBRE QHSE Approved PPE Kit

morethansafety

1601242

## Kit Content:

- 1010103M ~ Super KW Stockinette Mens Size M
- 1010106GRYL ~ PU Coated Glove Grey Large Size L
- 1010390GRNL ~ Kutstop Micro Foam Nitrile Green Cut Level 5 Glove 09/Large Size 09
- 2212286BLK ~ B-Brand Safety Bump Cap Black + CBRE Logo One Size
- 1103314 ~ Safety Helmet White + Chinstrap + CBRE One Size
- 1201315 ~ Folding Ear Defender One Size
- 1301136 ~ Clear Lens Safety Spectacle One Size
- 1401416 ~ Disposable P3 Mask Valved (Pack of 5) One Size
- 2211645SYL ~ Hi-Visibility Vest Saturn Yellow Large + CBRE Logo (Green) + CBRE Logo (Green) Size L
- 8200119L ~ Non-Slip Ice Gripper Black Size L
- 5973129 ~ WSID02G Ice Hard Hat ID Tag One Size
- 1010631 ~ Cut Resistant Sleeve 12" Size 12
- 6220109 ~ CBRE PPE Kit Bag One Size



# Safety Helmet

morethansafety

1103314

General purpose safety helmet with a 6 point plastic cradle.

## Features & Benefits:

- Weight: 375g
- Material: High Density Polyethylene (HDPE)
- Peak Type: Full (40mm)
- Internal Features: 6-Point Low Density Polyethylene (LDPE)
- Colour: White
- Full Peak Slip Vented with Brushed Nylon Sweatband
- Branding available on front, side & rear

EN Standards: EN 397:2012+A1:2012  
One Size



## CORPORATE BADGING



# Endurance Reduced Peak Safety Helmet

2217465

## Features & Benefits:

- Vented helmet shell to allow air circulation
- 6-point textile suspension harness for enhanced wearer comfort and safety
- Size adjustable headband via wheel ratchet system
- Y-style 4-point chin strap
- Compatible with PS58 helmet visor holder
- Available in multiple colourways

EN Standards: EN 397 -30°C/+50°C, LD

One Size  
Colour: White



# EVOLite Skyworker Industrial Climbing Helmet

**1102218**

The EVOLite Skyworker™ helmet has a suspension system and shell structure that has been designed to be used for industrial, mountaineering, rescue and leisure activities. Meeting the EN12492 standard.

## Features & Benefits:

- Strong Light Shell
- Conforms to the mandatory shock absorption and penetration requirements of EN397 industrial standard
- Fully adjustable 4-point chinstrap
- A 6-point textile harness system & Chamlo
- CR2 Reflective
- Available in multiple colourways
- Side & rear ventilation
- EPS Liner- side, front & rear impact protection

EN Standards: EN 12492 . EN 397  
One Size

**morethansafety**



Impact Resistance 100 Joules	Peak Micro
Maximum Temperature +50° C	Side Impact Resistance 25 Joules
ABS Shell Yes	Minimum Temperature -40° C
Textile Harness	Recyclable Shell
Wheel Ratchet Yes	Depth Adjustment 3D Harness
Ventilation Yes	Universal Accessories Slot Yes
ID card holder Optional	Reflective Option Optional
Fitted 4 point chinstrap (EN12492 Compliant) Fitted	BSI Kitemark Yes
Product Weight 382g	JSPCheck Yes
	Size 53-64cm

## Safety Bump Cap

**2217618**

Classic design bump-cap with ventilation ports for maximum breathability. Metallic ring holes for baseball cap look.

## Features & Benefits:

- Long peak (7cm) for maximum protection against shock and light
- Durable high density EVA protects and gives comfort to the wearer
- Inner ABS shell and soft pad for shock absorption
- Hook and loop strap for safe and secure fit
- Padded headband for comfort
- Available Colours
- Materials: Cotton, ABS EVA

EN Standards: EN 812  
One Size



# First Base Bump Cap

morethansafety

1102227

## Features & Benefits:

- Standard peak length
- Timeless look and appeal
- Lightweight micro-fibre fabric reduces humidity and permits air circulation
- Side mesh ventilation enhances breathability
- CE CAT 2 - Intermediate

EN Standards: EN 812  
One Size



# A1 Reduced Peak Bump Cap

1102081

Classic design bump-cap with ventilation ports for maximum breathability. Metallic ring holes for baseball cap look.

## Features & Benefits:

- Reflective piping on all models adds extra visibility
- Ventilation: Extra holes in the liner plus the two mesh panels on the outer
- All round protection
- Sweat Band terry towelling sweatband adds comfort and absorption
- Available Colours

EN Standards: EN 812  
One Size



# Ear Plug Dispenser Black (500 Plugs)

1208914

## Features & Benefits:

- Plastic dispenser with 500 pairs of ear plugs included
- Wall mountable for secure storage
- Easy to use turn wheel to dispense ear plugs
- Can stand on even surfaces
- CE certified// CE-CAT III

EN Standards: EN 352-2 SNR 34dB

# Ear Plug Refill Pack (500 Plugs)

1201317

## Features & Benefits:

- Disposable ear plugs made from soft PU foam
- Easy to fit
- Excellent attenuation rate
- CE certified// CE-CAT III
- Retail box which aids presentation for retail sales
- This product is sold in inner boxes

Material: PU Foam

EN Standards: EN 352-2 SNR 34dB

# Super Ear Protector

1201315

## Features & Benefits:

- Folds to palm size for better carriage and to keep clean
- Adjustable dual pin system provides multiple positioning for better fit
- Retail bag which aids presentation for retail sales & CE-CAT III

Material: Stainless Steel

EN Standards: EN 352-1 SNR 30dB

morethansafety





# Ear Defender

morethansafety

1201312

## Features & Benefits:

- Unique cup design
- Padded headband for user comfort
- Soft foam ear cushions for wearer comfort
- Ease of headband adjustment
- Can be folded for easy storage
- Lightweight materials, only 218g

EN Standards: EN352-1: 2002



# Optime 2 Ear Defender

1200142

## Features & Benefits:

- Optime II has been developed for demanding noise-hazard environments and muffles even extremely low frequencies to a maximum degree
- The sealing rings are filled with a unique combination of liquid and foam
- Optime II is a suitable choice for environments with substantial industrial noise or construction machinery, airports and agricultural work
- SNR 31db

EN Standards: EN 352



# TPR Easy Fit Ear Plugs

1201300

## Features & Benefits:

- TPR disposable ear plugs
- CE CAT 2 - Intermediate
- Low frequency = 23.00 dB
- Medium frequency = 23.00 dB
- High frequency = 27.00 dB

EN Standards: EN352-2:2002

Colour: Green

One Size

Suitable for:

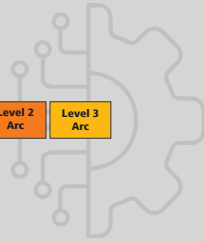

# Yale Safety Spec

1301136

## Features & Benefits:

- Ultra lightweight
- Wrap around design
- Contoured shape
- Polycarbonate lens (PC lens)
- Soft nose bridge
- Non slip coloured rubber tips

EN Standards: EN166 Optical Class:1, F - (Low impact energy) & 2C-1.2 - UV Filter

Suitable for:



# Balaclava

morethansafety

1751941

## Features & Benefits:

- Garment layering benefits for extra protection
- Extra soft Flame Resistant fabric
- Elastic fabric to fit all shapes & sizes
- LOI: Not Applicable
- Protection Type: Antistatic // Heat & Flame

EN Standards: EN 1149-5:2018: Pt. 5:2008 // Pt.

3:2004 // Charge Decay

EN ISO 11612:2015: A1 // B1 // C1

Colour: Navy

Gender: Unisex

Open ARC Test: Not Applicable

Box Test: Not Applicable

Suitable for:

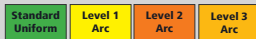

# Hi-Vis Anti-Static Flame Retardant Waistcoat

2218142

## Features & Benefits:

- Pinstripe detail
- Tear release front closure
- Two reflective bands around the body and one over each shoulder
- Available in Yellow & Orange
- Material: 100% recycled polyester

EN Standards: EN ISO 20471: 2013 + A1: 2016 class 2, EN14116 and EN1149.

Size: S-3XL

Suitable for:



# Endura 378 Arc Flash Drivers Glove

morethansafety

1010668

## Features & Benefits:

- DuPont™ Kevlar /composite filament fiber lining provides 360° ANSI Level A5 cut protection
- Padded palm for vibration dampening
- Arc Flash testing placed these gloves at level 3, with an Arc Thermal Performance Value (ATPV) of 36 cal/cm<sup>2</sup>
- Impact-resistant back-of-hand protection safeguards against knocks and bumps without impeding flexibility or dexterity
- High tensile strength goatskin provides outstanding abrasion resistance
- Treated with Oilbloc™ for unbeatable oil and water resistance

EN Standards: EN388:2016 3X22DP

Size: S-XL

Suitable for:



# Arc Gloves Khaki

1010621

## Features & Benefits:

- Box Test//Not Applicable
- LOI//Not Applicable
- Protection Type- ARC Flash // Heat & Flame
- Fabric: Not Applicable

EN Standards: EN 388:2003: Cut Level 5

EN 388:2016: 3.X.4.3.D

EN 407:2004: 4.2.3.2.2

Colour: Black

Gender: Unisex

Open ARC Test: EBT50=8.6 cal/cm<sup>2</sup> // ARC 2

Size: S-XL

Suitable for:

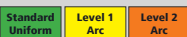

# ProGARM 2240 Kneepad

morethansafety

1700160

Flame Resistant certified gel foam kneepad designed for use with our range of Flame Resistant garments to improve comfort when kneeling. Cellular foam rubber for maximum comfort and wash performance.

## Features & Benefits:

OPTIONAL ITEM

- Notched sides // For maximum flexibility
- Excellent breathability // Due to air holes in the foam
- High Impact absorption // From high grade cellular rubber
- Wash tested to ISO 15797, 12 cycles // Perfect stability

Colour: Black

Gender: Unisex

Open ARC Test: Not Applicable

Box Test: Not Applicable

LOI: Not Applicable

Protection Type: Heat & Flame

Fabric: Not Applicable

EN Standards: EN ISO11612 Certified



1751942

## Features & Benefits:

### ASSEMBLY:

The assembly of hood, visor and helmet has been tested to and certified to EN 166:2002, GS-ET-29:2011 (APC 2), and ASTM F2178-ATPV 47 cal/cm<sup>2</sup>.

### FABRIC:

VXS+ Inherent special weave 395gsm outer shell fabric with VXS+ inherent 200gsm lining woven fabric, meeting the following standards:

EN ISO 11612:2015 // A1, B1, C1, D2, E3, F1

EN ISO 11611:2015 // Class 2, A1

EN 1149-5:2008

IEC 61482-2: Open Arc ATPV = 47 cal/cm<sup>2</sup> // Category 4

IEC 61482-2: Box Test = Class 2

### VISOR:

Premium anti-fog coated Highly Transparent Arc flash protective shield, colour grey, meeting the following standards:

NFPA 70E, ASTM F2178 - 47 cal/cm<sup>2</sup>

ANSI Z87.1

### HELMET:

Manufactured from high quality strong ABS material, up to 20% lighter than most other helmets, features Dry-Tech sweatband for maximum comfort and an adjustable ratchet. Meeting the following standards:

EN 397 - LD, MM, -40°C

EN 50365

ANSI/ISEA Class C

Colour: Navy

Gender: Unisex

Open ARC Test: ARC 4

Box Test: Class 2

LOI: Not Applicable

Protection Type: Antistatic // ARC Flash // Heat & Flame

Fabric: ProGARM VXS+ Inherent Special Weave

// ProGARM VXS+ Inherent Woven Weave // 395gsm

EN ISO 11611:2015: Class 2 // B1 // A1

EN ISO 11612:2015: A1 // B1 // C1 // D2 // E3 // F1

EN 1149-5:2008: Pt. 5-2008 // Pt. 3:2004 // Charge Decay

IEC 61482-2:2009: Class 2 // ATPV=47 cal/cm<sup>2</sup> // ARC 4

Suitable for: 



1103335

## Features & Benefits:

### HELMET:

Made of ABS

Suitable for live working

Smooth head circumference adjustment, range 53cm-63cm Helmet type (ANSI standard) - Type 1

Lateral deformation resistance (EN Standard) - LD

Molten metal splash resistance (EN Standard) - MM

Resistance to penetration after conditioning in temperatures of -40°C to +60°C

Electrical properties (EN standard) - 440 Vac

Electrical Class O (1000 V AC/1500 V DC) according to EN 50365 Electrical Class E (20kV AC) according to ANSI Z89.11

Compliance with ANSI Z89.1; EN397; EN 50365 standards Approved to EN 50365 - Electrically insulating helmets for use on low voltage installation

Approved to ANSI Z89.1 - Industrial head protection

Improved visibility with reflective stickers

Manufacturing date and utilisation date permanently marked

### FACE SHIELD:

Made from Polycarbonate

Protection against high-speed particles - B

Protection against droplets and splashes of liquids (3)

Full face, chin and neck protection against thermal hazards caused by electric arc flash

Resistance to fogging - N

Protection against electric arc: Class 2 - Box test 7kA/0.5s; ATPV > 36cal/cm<sup>2</sup>

Compliance with standards: EN 166; GS-ET-29; ASTM F2178 Code number for ultra-violet filter (UV) - 2C-2

Visible light transmittance (VLT) < 50% - Class 2

Optical Class - 1

Protection against molten metals and hot solids (9)

Approved to ASTM F2178

Premium class anti-fog and anti-scratch protection

Easy to wear with eyeglasses

Incident energy - ATPV = 36cal /cm<sup>2</sup>

### CHIN STRAP:

4-point strap recommended for working at height

Quick, clasp - easy operation with protective gloves

Size: One Size

Colour: White

Gender: Unisex

Box Test: Class 2

LOI: Not Applicable

Protection Type: Antistatic // ARC Flash // Heat & Flame

Fabric: Not Applicable

EN 397:2012 +A1:2012

EN 50365:2002

EN 166:2001

Suitable for:

Level 2  
Arc

Level 3  
Arc



# Fold Flat P3 Mask Valved (Pack of 20)

morethansafety

1401416

## Features & Benefits:

- Maintenance free particulate respirator
- Polypropylene (P.P) outer layer provides smooth lining and avoids loose fibres
- Latex free synthetic rubber head strap
- Contour design ensures the compatibility of glasses / goggles and reduces fogging
- Soft close-cell nose foam and adjustable nosepiece

EN Standards: EN149:2001 + A1:2009 FFP3 NR V



# B-Brand P3 Mask Valved (Pack of 5)

1400144

## Features & Benefits:

- "Big Eye" design provides very low breathing resistance due to the increased filtration area
- Adjustable head strap ensures the best facial seal with minimum leakage
- Full facial close-cell foam seal for improved fit
- Polypropylene (P.P) outer layer provides smooth lining and avoids loose fibres
- Adjustable nose piece ensures increased worker comfort and acceptance
- Protection level FFP3 with exhalation valve

EN Standards: EN149:2001 + A1:2009 FFP3 NR



# A2 P3 Organic

1400106

## Features & Benefits:

- 3M 4255+ Maintenance Free Gas/Vapour and Particulate Respirator
- Soft, close-fitting face seal made with textured, non-allergenic material
- Includes a resealable bag for hygienic storage and transportation
- A newly enhanced valve assembly helps to reduce exhalation breathing resistance

EN Standards: EN 405:2001+A1:2009





# Foam Knee Pad Black

morethansafety

1700893

## Features & Benefits:

- Ergonomically designed to hug your knee
- Fits all Portwest knee pad pockets
- Does not impede when walking
- Retail bag which aids presentation for retail sales
- CE certified & UKCA marked
- 21.5cm x 16.5cm x 1.5cm
- Material: EVA Foam

EN Standards: EN 14404: 2004 + A1:2010 Type 2 Level 0



# Poly Ridged Knee Pad

1700104

## Features & Benefits:

- Deluxe model offering excellent protection
- Made using non marking material
- Rubber-like surface with grip ridges help prevent sliding and slipping
- Hook and loop Adjustable straps
- This product is sold in pairs

EN Standards: EN 14404: 2004 + A1: 2010 Type 2 Level 0



# Ultimate Gel Knee Pad

1700161

## Features & Benefits:

- Tough abrasion resistant PVC shell
- Thick silicone gel adapts to your kneecap
- Ergonomically designed and tested straps ensure no pinching to the back of the wearers leg
- CE certified & UKCA marked
- Materials: PVC Shell, Nylon, EVA Foam

EN Standards: EN 14404: 2004+A1: 2010 Type 1 Level 1



# Disposable Boiler Suit

more**th**ansafety

2400114

## Features & Benefits:

- Hooded coverall
- Robust, yet lightweight
- 3 piece hood
- Elasticated face, wrist and ankles
- Excellent barrier to fine particles and fibres
- Ultra-low linting
- Stitched external seams
- Elasticated waist (glued-in)
- Elasticated wrists, ankles and face
- CAT III, TYPE 5B, 6B

EN Standards: EN 1073-2, EN 1149-5, EN14126

Colour: White

Size: S-XXL



# Poly/Cotton Boilersuit

2217173

## Features & Benefits:

- 65% polyester, 35% cotton
- Concealed two-way zip
- 2 zip breast pockets
- Reinforced elasticated waist
- Double pen pocket on sleeve
- 2 swing hip pockets with side access
- 2 rear pockets, one with hook and loop fastening
- Knee pad pockets
- 1 rule pocket
- Hammer loop

Size 36"- 54"



# Test Equipment



# LV Isolation Kit

5552672

## Kit Content:

- Kewtech KT1780 2 Pole LED Voltage Tester
- Kewstick Duo Non-Contact Voltage Detector
- Kewtech Proving Unit
- KTPI Non-Contact Proving Unit
- Yale Clear Lens Spectacle
- 18-Gauge Flame resistant Arc Flash Glove
- Small Clear Front Pocket Bag For Isolation Kits



# Authorised Persons LV Isolation Kit

5552673

## Kit Content:

- Kewtech KT1780 2 Pole LED Voltage Tester
- Kewstick Duo Non-Contact Voltage Detector
- Kewtech Proving Unit
- KTPI Non-Contact Proving Unit
- Yale Clear Lens Spectacle
- 18-Gauge Flameresistant Arc Flash Glove
- Small Clear Front Pocket Bag For Isolation Kits



# KT65 Multifunction Tester

morethansafety

5551218

Proven multifunction tester combining the latest anti-trip technology, phase rotation, earth resistance & advanced memory, with easy to use functionality. Specifically designed for the UK market.

## Features & Benefits:

- Easy to use
- Phase rotation in line with new 18th Edition requirements
- Advanced memory with free software, eg you can save a continuity test as an r1, r2, rn, R2 or R1+R2 and on which circuit
- Powerful 18th Edition software available optionally from Castline Systems
- NEW Anti-Trip Technology for full no trip LOOP testing on all RCD types
- Test button in probe as well as lockdown test button for 'hands free' testing
- Easy PFC & PSC measurement without the need to alter test probes
- 250, 500 & 1000V insulation tests with auto discharge
- Additional LED for warning of high voltage output in insulation test mode
- Memory for test lead resistance compensation
- Backlit display
- Auto-test memory for RCD testing with all results shown on one screen
- Conducts phase to phase loop tests
- Earth resistance for earth rods (with optional Earth Spikes)
- End of line calibration certificate included
- Comes with easily removed and stored lid for excellent protection when not in use
- Can be used with rechargeable batteries
- Complies with BS7671 (Part P)



## Includes:

ACC064SP G7 test lead with remote test button  
ACC065 G7 Test lead set  
Batteries  
Instruction Manual  
Certificate of conformity  
End of line Certificate  
KAMP 12 Mains lead  
Test lead pouch  
Soft carry case

## Weight & Dimensions:

Boxed Weight: 3.6kg  
Boxed Dimensions: 320(W)x275(H)x235(D)mm

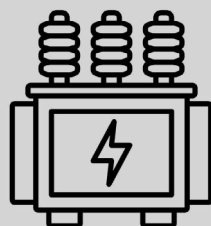

# KT66DL and EVSE Adapter Testing Kit

morethansafety

5552703

## Features & Benefits:

- The KT66DL has many great features including a low current two & three wire test and a 25A, 0.001 Ohm resolution high current test allowing for PSC readings of up to 50 kA.
- It has two special options of EV loop test currents to overcome sensitive inbuilt tripping devices. It also tests type B & EV RCDs and 6 mA RDC-DDs for time and tripping level.
- The user interface is flexible and enables you to do the RCDs tests as part of an auto-test or individually.
- The KEWEVSE enables electrical safety tests with the KT66DL by simulating the presence of an electric vehicle and opening up the supply circuits to enable testing. It facilitates the testing of single and three phase charging stations as well being able to simulate earth faults to test whether the charging point closes down.
- There are 4mm connectors and a BS1363 three pin socket to enable connection to your MFT. Red LEDs indicate which phases are live.



## EVSE Adapter

### Features & Benefits:

- Compact - smallest in class
- Easy to use
- Allows for the electrical safety checks of a charging point in conjunction with an EVSE enabled MFT, like the KT66DL
- Checks the functionality of the EVSE
- Used for commissioning and trouble shooting
- For use on single phase or three phase systems
- Type 2 male connector for EVSE connection
- 4 mm connectors and alternative BS1363 socket for connecting your tester
- CP & PP state adjustment rotary switches
- PE error & CP error simulation test
- Oscilloscope output
- Printed manual
- Carry case included



# Kewtech Smartpat PAT Tester

morethansafety

5551654

## Features & Benefits:

- Easy to use
- Converts into a full downloading PAT Tester with the KEWPAT APP
- Automatic test sequences - standard or make your own
- Large easy to read display
- Battery operated - approx. 1400 tests
- IT safe with 200mA earth test and 250V insulation option
- PASS / FAIL - Green / Red screens
- Run / leakage at supply voltage (110V or 230V)
- Portable RCD tests 10mA & 30mA
- Performs Earth bond at 200mA (IT safe)
- Converts into a full downloading PAT tester with the KEWPAT APP
- Automatic test sequences - make your own with the KEWPAT APP
- For fast data collection and results saving works in connection with the KEWPAT APP
- PASS / FAIL - Green / Red screens
- Appliance status pre-check
- Quick check continuity
- 5 second continuity
- 250 V and 500 V insulation
- Substitute leakage test
- Selectable substitute leakage limits
- Extension lead test
- Test lead nulling
- Back light
- Extension lead adapter
- Earth Continuity test lead with probe and croc clip
- Carry bag with handle
- Quick start guide



## Includes:

- Extension lead adapter (EZYLEAD)
- Earth continuity test lead with probe and croc clip (EZYEARTH)
- Mains Lead (EZYMAIN)
- Carry bag with strap

## Weight & Dimensions:

- Boxed Weight: 1.84kg
- Boxed Dimensions: 290(L)x140 (W)x130(D)mm

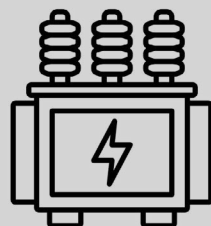

# 815 Class 2 Sound Level Meter

5500114

The testo 815 sound level meter can be used for control measurements in the air conditioning and heating area, on combustion systems or at workplaces.

## Features & Benefits:

- Heating technology: measurement of the volume of burners
- Industry and trade: measurement of machinery noise
- Event technology or public authorities: noise levels at events
- Building services: simple measurements by the caretaker when there are complaints
- Test whether the charging point closes down
- There are 4mm connectors and a BS1363 three pin socket to enable connection to your MFT. Red LEDs indicate which phases are live



# 540 Pocket Pro Lux Meter

5500143

## Features & Benefits:

The testo 540 light meter can be used to measure both artificial and natural light and provides you with a quick and easy means of measuring lighting conditions in the workplace.

The testo 540 light meter is a compact entry level model designed specifically for carrying out spot checks in the workplace, shops and offices. The light sensor is modelled on the spectral sensitivity of the human eye and is ideal for measuring lighting conditions in a variety of different workplaces.

The compact, easy-to-use meter has a number of useful functions and features including a large, easy-to-read display, min/max values which can be shown at the touch of a button, a hold function that allows you to freeze the last reading and a protective cap for safe storage.





# 410-1 Compact Vane Anemometer NTC Air Thermometer

morethansafety

5500116

The testo 410-1 includes a plug-on protective cap, as well as a wrist strap for secure measurement, and enables you to take advantage of the following functions:

## Features & Benefits:

- Single-point averaging: provides information on the average air velocity, e.g. at air outlets
- Hold function: is used to record the current values relating to air velocity and air temperature and compare them with each other
- Max/min values: get the minimum or maximum values since the anemometer was last switched on or reset, at the touch of a button
- Illuminated display: read off your readings even in dark environments
- Selectable units: for air velocity and temperature: m/s, km/h, fpm, mph, kts, Beaufort, °C, °F and wind chill



## Overview:

The testo 410-1 vane anemometer is impressive thanks to its practical pocket size and is ideal for fast check measurements. With a measuring range of 0.4 to 20 m/s, the anemometer can even be used for low flow speeds.

The anemometer has a permanently mounted vane with a diameter of 40 mm. You can therefore use it for the integral measurement of air velocity at ventilation grilles (air outlets).

The anemometer is practical for outdoor operation: as well as air velocity and air temperature, the testo 410-1 also calculates the Beaufort wind force and the wind chill temperature, which is the temperature perceived by a person due to wind-related cooling.



# 440 Air Velocity and IAQ Measuring Instrument

5551703

morethansafety

## Features & Benefits:

- A measuring instrument for all climate related parameters
- Extendible with a wide range of probes
- Wireless measurement with bluetooth probes
- USB interface for exporting measurement reports as CSV files
- Intuitive measurement menus
- Graphic display with parallel display of 3 readings



## Overview

Precise, reliable measurement of all air velocity and IAQ parameters with just one measuring instrument: the multifunction measuring instrument features intuitive operation with clearly structured measurement menus.

Adjusting air conditioning and ventilation systems, monitoring air quality or carrying out comfort level measurements – thanks to versatile options for combining with high-quality, digital probes, you are ideally equipped to carry out your measuring task (please order probes separately)

### General technical data:

Weight-250 g

Dimensions-154 x 65 x 32 mm

Operating temperature-20 to +50 °C

Connectable probes

1 x digital probe with cable or 1 x Temperature NTC TUC, 1 x digital Bluetooth probe or testo Smart Probe, 1 x Temperature TC Type K

Battery type 3 AA mignon 1.5 V

Battery life: 12 h (typically vane measurement)



# 610 Compact Humidity Temperature Meter

morethansafety

5501109

With its built-in NTC temperature sensor, the testo 610 thermohygrometer offers great accuracy when it comes to temperature measurement. The thermohygrometer measures humidity using its capacitive humidity sensor which is characterized by its long-term stability. The two sensors make the testo 610 a reliable and durable thermohygrometer.

The thermohygrometer is easy to use: the current temperature and humidity values are easily legible on the illuminated display. In addition, it can display the calculated dew point and wet bulb temperature, as well as min./max. values. With its clip-on protective cap, wrist strap and belt pouch, the handy thermohygrometer can be safely stored and easily taken along to any measuring location.

## Delivery Scope

testo 610 thermohygrometer, protective cap, calibration protocol, belt pouch and batteries.



# Blackline G7c Unit (Quoted spec for contract)

Contact us to specify your unit

Blackline Safety's G7c uses integrated 4G/2G or 3G/2G connectivity to wirelessly link your team to real people, while automating data analytics and compliance reporting.

All safety incidents are communicated to 24/7 live monitoring personnel who can mobilise responders to an employee's exact location or trigger an evacuation in real-time.

With a two-way speakerphone, monitoring personnel can communicate directly with the worker, providing critical insights and situational awareness for optimised emergency responses.



# Testo 868s Thermal Imaging Camera

morethansafety

5501345

## Features & Benefits:

- Image quality with IR resolution of 160 x 120 pixels (with testo Super Resolution technology 320 x 240 pixels)
- Thermal sensitivity of 0.08 °C
- Free analytical software for creating professional reports
- Automatic detection of hot and cold spots
- Thermal images can be saved as JPEGs
- App for analysis and creating on-site measurement reports



## Technical data:

<b>Infrared image output</b>		<b>Image storage</b>	
Infrared resolution	160 x 120 pixels	File format	.bmt and .jpg; export options in .bmp, .jpg, .png, .csv, .xls
Thermal sensitivity (NETD)	<0.08 °C (80 mK)	Memory	Internal memory (2.8 GB)
Field of view/min. focusing distance	31° x 23° / < 0.5 m	<b>Power supply</b>	
Geometric resolution (IFOV)	3.4 mrad	Battery type	lithium ion rechargeable battery exchangeable on site
testo SuperResolution (pixels/IFOV)	320 x 240 pixels	Operating time	4 hours
Image refresh rate	9 Hz	Charging options	In instrument/in charging station (optional)
Focus	Fixed focus	Mains operation	✓
Spectral range	7.5 to 14 µm	<b>Ambient conditions</b>	
<b>Visual image output</b>		Operating temperature range	-15 to +50 °C
Image size / min. focusing distance	5 MP / min. 0.5 m	Storage temperature range	-30 to +60 °C
<b>Image presentation</b>		Air humidity	20 to 80 %RH, non-condensing
Image display	8.9 cm (3.5") TFT, QVGA (320 x 240 pixels)	Housing protection class (IEC 60529)	IP64
Display options	IR image / real image	Vibration (IEC 60068-2-6)	2G
Colour palettes	iron, rainbow HC, cold-hot, grey	<b>Physical features</b>	
<b>Data interface</b>		Weight	510 g
WLAN Connectivity	Communication with the testo Thermography App Wireless module WLAN (EU, EFTA, USA, AUS, CDN, TR)	Dimensions (LxWxH)	219 x 96 x 95 mm
USB 2.0 micro B	✓	Housing	PC - ABS
<b>Measurement</b>		<b>PC software</b>	
Measuring ranges	Measuring range 1: -30 to +100 °C Measuring range 2: 0 to +650 °C Manual/automatic switchover	System requirements	Windows 10, Windows 8.1
Accuracy	±2 °C, ±2 % of measured value (higher value applies)	<b>Standards, tests</b>	
Emissivity/reflected temperature adjustment	0.01 to 1 / manual	EU Directive	EMC: 2014/30/EU RED: 2014/53/EU
testo e-Assist	Automatic recognition of emissivity and determination of reflected temperature (RTC)	<b>Standards, tests</b>	
<b>Measuring functions</b>		<b>Standards, tests</b>	
Analysis functions	Centre point measurement, hot/cold spot detection, delta T	<b>Standards, tests</b>	
testo ScaleAssist	✓	<b>Standards, tests</b>	
IFOV warner	✓	<b>Standards, tests</b>	
<b>Imager features</b>		<b>Standards, tests</b>	
Digital camera	✓	<b>Standards, tests</b>	
Lens	31° x 23°	<b>Standards, tests</b>	
Video streaming	via USB via WLAN with testo Thermography App	<b>Standards, tests</b>	
Storage as JPG	✓	<b>Standards, tests</b>	
Fullscreen mode	✓	<b>Standards, tests</b>	

## Overview

With the testo 868s thermal imager, we have developed a thermal imager which makes work quicker and easier – without foregoing professional thermal imaging technology.

You can generate error-free and objectively comparable infrared images using its handy functions. The IFOV warner, testo Assist and testo Scale Assist mean you can avoid measurement errors and not only effortlessly achieve optimum setting of emissivity (and reflected temperature (RTC) for building thermography, but also of colour scale.

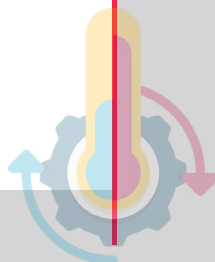

# LOTO



# Electrical Mobile LOTO Kit

morethansafety

6030079

## Kit Content:

- 6030059 ~ Steel Shackle Red LOTO Padlock Steel Shackle Length 38mm
- 6030061 ~ PA Coated Steel Hasp Lock Shackle 1" (25mm)
- 6030062 ~ Nylon Lockout Hasp (43mm x 173mm)
- 6030065 ~ Miniature Circuit Breaker Lockout Pin Out Standard
- 6030066 ~ Miniature Circuit Breaker Lockout Pin In Standard
- 6030067 ~ Simple Circuit Breaker Lockout (45mm x 25mm x 10mm)
- 6030068 ~ Simple Circuit Breaker Lockout (51mm x 25mm x 23mm)
- 6030069 ~ Simple Circuit Breaker Lockout
- 6030071 ~ Simple Circuit Breaker Lockout
- 6030071 ~ Simple Circuit Breaker Lockout (125mm x 63mm x 40mm)
- 6030073 ~ Clamp-On Breaker Lockout Oversize - 480V to 600V
- 6030076 ~ Simple Cable Lockout
- 6011083 ~ Permanent Marker Pen For Writing On Tags
- 5904403 ~ Draper Expert 3.0mm x 100mm Fully Insulated Plain Slot Screwdriver (Sold Loose)
- 6011704 ~ Tag - Double Sided CBRE Printed Inspection/Caution (Pack of 10)
- 6011703 ~ Tag - Single Sided CBRE Printed Live Equipment Do Not Touch (Pack of 10)
- 6220033 ~ CBRE Approved Mobile LOTO Bag (Electrical)

Please see web for more detail



6030080

## Kit Content:

- 6030059 ~ Steel Shackle Red LOTO Padlock Steel Shackle Length 38mm
- 6030061 ~ PA Coated Steel Hasp Lock Shackle 1" (25mm)
- 6030062 ~ Nylon Lockout Hasp (43mm x 173mm)
- 6030065 ~ Miniature Circuit Breaker Lockout Pin Out Standard
- 6030066 ~ Miniature Circuit Breaker Lockout Pin In Standard
- 6030067 ~ Simple Circuit Breaker Lockout (45mm x 25mm x 10mm)
- 6030068 ~ Simple Circuit Breaker Lockout (51mm x 25mm x 23mm)
- 6030069 ~ Simple Circuit Breaker Lockout
- 6030070 ~ Simple Circuit Breaker Lockout
- 6030071 ~ Simple Circuit Breaker Lockout (125mm x 63mm x 40mm)
- 6030073 ~ Clamp-On Breaker Lockout Oversize - 480V to 600V
- 6030076 ~ Simple Cable Lockout
- 6011083 ~ Permanent Marker Pen For Writing On Tags
- 5904403 ~ Draper Expert 3.0mm x 100mm Fully Insulated Plain Slot Screwdriver (Sold Loose)
- 6011704 ~ Tag - Double Sided CBRE Printed Inspection /Caution (Pack of 10)
- 6011703 ~ Tag - Single Sided CBRE Printed Live Equipment Do Not Touch (Pack of 10)
- 6220033 ~ CBRE Approved Mobile LOTO Bag (Electrical)

Please see web for more detail



# HVAC Mobile LOTO Kit

morethansafety

6030081

## Kit Content:

- PA Coated Steel Hasp Lock Shackle 1" (25mm)
- Nylon Lockout Hasp (43mm x 173mm)
- Adjustable Ball Valve Lockout (0.5" to 2.5")
- Adjustable Ball Valve Lockout (1.5" to 2.5")
- Miniature Circuit Breaker Lockout Pin Out
- Miniature Circuit Breaker Lockout Pin In
- Simple Circuit Breaker Lockout (45mm x 25mm x 10mm)
- Simple Circuit Breaker Lockout (51mm x 25mm x 23mm)
- 6030069 ~ Simple Circuit Breaker Lockout
- 6030070 ~ Simple Circuit Breaker Lockout
- Clamp-On Breaker Lockout Oversize (480V to 600V)
- Gate Valve Lockout (5" to 6.5")
- New Gate Valve Lockout (1" to 2.5")
- Permanent Marker Pen For Writing On Tags
- Tag - Double Sided CBRE Printed Inspection /Caution (10 pack)
- Tag - Single Sided CBRE Printed Live Equipment Do Not Touch (Pack of 10)
- CBRE Approved Mobile LOTO Bag (Refrigeration)
- Steel Shackle Red LOTO Padlock Steel Shackle Length 38mm
- 6030071 ~ Simple Circuit Breaker Lockout (125mm x 63mm 40mm)
- Draper Expert 3.0mm x 100mm Fully Insulated Plain Slot Screwdriver (Sold Loose)
- Simple Cable Lockout







# Group Lockout Box

6030087

## Features & Benefits:

Global Standard for Simple Group Lockout and simplifies the lockout of larger machines. After the equipment to be worked on has been isolated from the energy source, the lockout keys are placed inside the multiple lockout box and then padlocked by the controlling person.

Each person then working applies their own unique padlock to the lockout box. Only when all unique padlocks have been removed (including the controller's padlocks) can the necessary keys be re-issued to re-start.



# Lockout Bag

6030072

This lockout bag is best used for locking out junction boxes and elevator controllers.

Simply slide the device inside, tighten the top of the bag and lock out the cord to ensure the bag cannot be pulled off. Made from wear resisting polyester cloth and features a PVC liner to prevent others from making contact with any buttons through the bag.

Can lock out many kinds of driving controller buttons or all kinds of special large sized plugs and accessories



## Features & Benefits:

- Bag dimensions 440 x 250mm
- Strap can be locked out by up to 6 padlocks or hasps

# Cylinder Tank Lockout

6030075

Prevents access to the main cylinder valve with no need to match your lockout device to varying diameter and threads of cylinder caps. Can be locked out by up to 3 padlocks simultaneously. The lock body front is suitable for writing on.

## Content:

- Maximum diameter neck ring of 80mm
- Padlock shackle diameter up to 7mm
- Made from engineering plastic PP



6030082

## Content:

- 6030059 ~ Steel Shackle Red LOTO Padlock Steel Shackle Length 38mm
- 6030061 ~ PA Coated Steel Hasp Lock Shackle 1" (25mm)
- 6030062 ~ Nylon Lockout Hasp (43mm x 173mm)
- 6030063 ~ Adjustable Ball Valve Lockout (0.5" to 2.5")
- 6030064 ~ Adjustable Ball Valve Lockout (1.5" to 2.5")
- 6030065 ~ Miniature Circuit Breaker Lockout Pin Out Standard
- 6030066 ~ Miniature Circuit Breaker Lockout Pin In Standard
- 6030067 ~ Simple Circuit Breaker Lockout (45mm x 25mm x 10mm)
- 6030068 ~ Simple Circuit Breaker Lockout (51mm x 25mm x 23mm)
- 6030069 ~ Simple Circuit Breaker Lockout
- 6030070 ~ Simple Circuit Breaker Lockout
- 6030071 ~ Simple Circuit Breaker Lockout (125mm x 63mm x 40mm)
- 6030073 ~ Clamp-On Breaker Lockout Oversize (480V to 600V)
- 6030076 ~ Simple Cable Lockout
- 6030077 ~ Gate Valve Lockout (5" to 6.5")
- 6030078 ~ New Gate Valve Lockout (1" to 2.5")
- 6011083 ~ Permanent Marker Pen For Writing On Tags
- 5904403 ~ Draper Expert 3.0mm x 100mm Fully Insulated Plain Slot Screwdriver (Sold Loose)
- 6011704 ~ Tag - Double Sided CBRE Printed Inspection /Caution (Pack of 10)
- 6011703 ~ Tag - Single Sided CBRE Printed Live Equipment Do Not Touch (Pack of 10)
- 6210167 ~ CBRE Branded Static Wall Mounted Lock Out Station Yellow



## Electrical Plug Lockout 3 Pin

6030088

### Features & Benefits:

- Self-locking Computer industrial host Safety lockout device with rubber stopple for lockout

## 9270004

Orientation: Landscape  
Size: 1804 x 1204mm

Design printed onto 100 micron white gloss self-adhesive vinyl, laminated with dry wipe film, and applied to 5mm PVC white foam board and mounted onto 10mil black PVC foam.

### Supplied with:

- 2 Key cabinets
- 32 Red padlocks
- 2 x A4 Transparent Document Holders
- 3 x A6 Transparent Document Holders
- Self tapping screws for use with document holders and key cabinets
- Cup hooks for use with padlocks for lock out stations

**Notes:** Artwork not to size. Please allow 10 working days for production. Items may also vary due to changes in QHSE Approved LOTO.

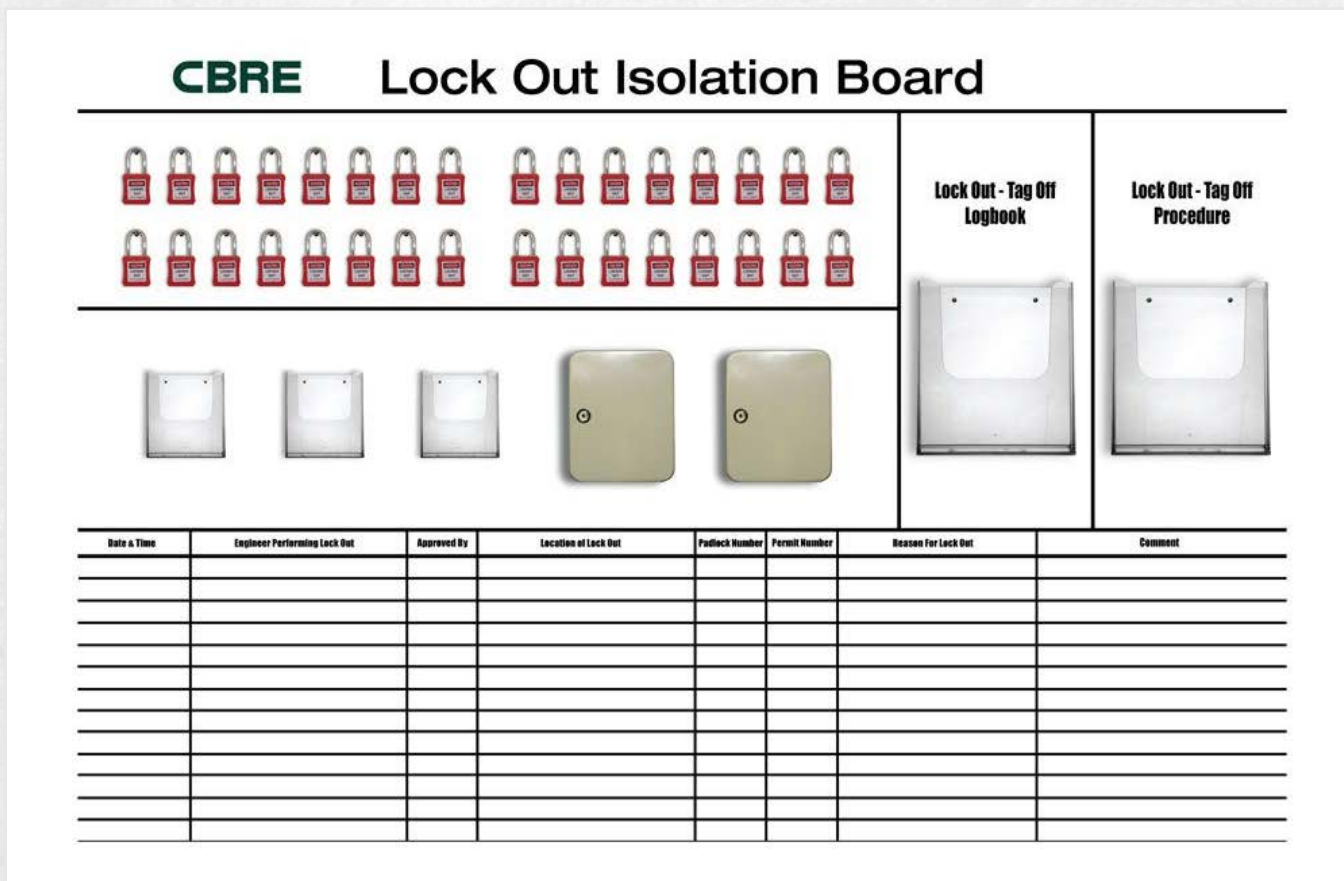



# Workplace



# Glassfibre Swingback Step Ladder

morethansafety

**6102965**

The Murdoch GRP swingback steps are manufactured to withstand vigorous every-day usage. Carrying the EN131 professional label means that the product has been tested to withstand at least 50,000 uses. The fibre-glass stiles makes this step your ideal partner when working around electricity. The spreader arm makes opening/closing of the stepladder simple, plus a heavy duty tool tray creates another user friendly touch.

## Features & Benefits:

- Tested to 30,000 Volts
- 80mm deep treads for comfortable standing
- 2 locking arms for safety and usability
- Large anti-slip feet for ultimate grip
- Load rating 150kg
- EN131 Professional



# Heavy Duty Professional Glassfibre Swingback Step Ladder

**6102183**

This range of ladders is ideal for trade use and is tested to a durability test of 50,000 cycles. Tested & certified to New EN131-2, Professional Improved stiles and strengthened treads as well as reinforced platform in-line with the new standard requirements.

Unique strengthening beam incorporated into non-slip treads, rubber feet, and twists as there are no tapes to snap, or flimsy arms to break. Rigid box section back legs with additional cross braces and 'k' straps for increased strength and stability.

Non conductive to 30,000 volts and so the ladder is ideal for use where electrical hazards exist.

Lower bottom tread to avoid bending of front feet. Plastic tool tray to hold tools and equipment while working.



# Lytepod Adjustable Low Level Platform

morethansafety

6100573

## Features & Benefits:

- Low Level Aluminum Podium Steps. Low Level Access Certified to BS8620
- Saloon gates for easy access and egress, stoppers for extra safety
- Only 2 removeable parts: platform deck and access ladder
- All models have 2 platform heights
- Anti surf as standard Compact folding dimensions. Toe boards are available
- Non removeable stabilisers



# Teletower

6100208

The World's First Telescopic Mobile Scaffold Tower.

## Features & Benefits:

Telescopic mechanism allows seven different platform heights from 0.33 to 2.00 metres - Working heights from 2.30 to 4.00 metres  
Large folding aluminium work platform (1.4m x 0.7m) with climb through hatch  
Fully erected in under 3 minutes, saving down time & man hours  
Operates as a podium with low level fixed height options of 33cms & 61cms  
Comprises only two parts - tower and platform (no more leaving parts in the yard!)  
Integral stabilising legs with 5 optional positions & lockable castors  
Includes toe-boards as standard  
Integral telescopic hand & knee rails-Integral platform stabilisers  
Conforms to EN1004





# Glidelift Low Level Access Desk Surfer

morethansafety

6100282

The height adjustable access platform for all work up to a reach height of 4m. Evolved from our Deskglider, the hugely popular over desk platform, The Glidelift still retains its over desk capability but at last offers the most versatile, low cost, low level access platform on the market.

## Features & Benefits:

- 4.00M Reach height
- 2.00M Platform height
- Lightweight 90kg
- 150KG Safe working load
- Height adjustable platform
- Compact - fits through single doors (inside & outside use)
- No assembly required
- Easily transportable
- Quick and easy to use
- Work at height compliant



# Ladder Tag Kit

6011714

## Kit Content:

- Replacement CBRE Ladder Tags(Pack of 20)
- Tag holders (20)
- Pen for writing on tags (20)



# 1 Person Travel First Aid Kit

morethansafety

7011726

## Features & Benefits:

- Small, compact, zip bag
- Easy to fit in rucksack
- Light weight

### Content:

- Cleansing Wipes (Sterile) QTY x2
- Washproof Plasters QTY x10
- Triangular Bandage QTY x2
- Gloves (Pair) QTY x2
- Large Sterile First Aid Dressing 18cm x 18cm QTY x1



First Aid

# 10 Person Workplace HSE Compliant First Aid Kit

7011727

The Standard Workplace Kit is low-medium risk ideal for small offices, shops, and libraries etc. Essential kits for variety of needs - from general first aid and catering to burns, eyewash and biohazards. A compact and durable comprehensive HSE compliant range.

## Kit Content:

- Safety Pins
- Triangular Bandages
- Eye Pad Sterile Dressing
- Medium Sterile Dressing
- Large Sterile Dressing
- Nitrile Disposable Gloves Conforming to BS EN 455-1 and BS EN 455-2, large size (8-9)
- Saline Cleansing Wipes
- Plasters
- Guidance Leaflet



# 20 Person Workplace HSE Compliant First Aid Kit

7011728

The Standard Workplace Kit is low-medium risk ideal for small offices, shops, and libraries etc. Essential kits for variety of needs - from general first aid and catering to burns, eye-wash and biohazards. A compact and durable comprehensive HSE compliant range.

## Kit Content:

- Safety Pins
- Triangular Bandages
- Eye Pad Sterile Dressing
- Medium Sterile Dressing
- Large Sterile Dressing
- Nitrile Disposable Gloves Conforming to BS EN 455-1 and BS EN 455-2, large size (8-9)
- Saline Cleansing Wipes
- Plasters
- Guidance Leaflet



# 50 Person Workplace HSE Compliant First Aid Kit

7011705

The Standard Workplace Kit is low-medium risk ideal for small offices, shops, and libraries etc. Essential kits for variety of needs - from general first aid and catering to burns, eye-wash and biohazards. A compact and durable comprehensive HSE compliant range.

## Kit Content:

- Safety Pins
- Triangular Bandages
- Eye Pad Sterile Dressing
- Medium Sterile Dressing
- Large Sterile Dressing
- Nitrile Disposable Gloves Conforming to BS EN 455-1 and BS EN 455-2, large size (8-9)
- Saline Cleansing Wipes
- Plasters
- Guidance Leaflet



# Large BS 8599-1 2019 Catering First Aid Kit

morethansafety

7011729

The Blue Dot BS 8599-1 (2019) First aid kits have been put together especially for use in the food service industry. With health and safety being a priority in catering establishments, these kits are essential for when an accident occurs, and immediate aid is required. These kits fully conform to the BS8599-1:2019 legislation.

## Kit Content:

- Instructions
- Contents Leaflet
- Medium Dressing 12cm x 12cm
- Large Dressing 18cm x 18cm
- Triangular Bandage
- Eye Pad & Bandage
- Blue Detectable Plasters
- Cleansing Wipes (Sterile)
- Blue Microporous Tape
- Nitrile Gloves (Pair)
- Blue Finger Dressing 3.5cm x 3.5cm
- Revive Aid (Resuscitation Device)
- Thermal Blanket
- Burn Dressing 10cm x 10cm
- Tuff Cut Scissors
- Conforming Bandage 7.5cm x 4.5cm



# Standard Burns First Aid Kit

7010457

Blue Dot Burns Kit is effective for use at work or home and provides effective relief from a variety of burns including, scalds and sunburn. The Blue Dot Burns Kit is available in two sizes – small and medium and is an essential requirement with the workplace. Particularly where the risk of getting burn related injuries is higher.

## Kit Content:

- Burn Dressing 20cm x 20cm
- Burn Dressing 10cm x 10cm
- Low Adherent Dressing 10cm x 10cm
- Low Adherent Dressing 10cm x 20cm
- Burn Gel Sachet
- Eye Wash Pods
- Crepe Bandage
- Conforming Bandage
- Gloves
- Microporous Tape
- Scissors



# Standard Eye Wash Station

morethansafety

7011731

Strong ABS plastic with clear front and integrated wall bracket. Contents are kept dust and damp free. Items can be individually refilled.

## Kit Content:

- 2x Sterile Eye Pad Dressing
- 2x Sterile Eye Wash Bottles



# First Aid Box Wall Bracket

7011730

A simple and cost-effective wall mounting bracket for first aid kits. The bracket allows for the kit to be easily removed and used where an incident has occurred.

It is suitable to be used with all of our first aid boxes.



# AED Emergency Response Kit

7011732

The ideal kit to pair with Defibrillators

## Kit Content:

- 1x Razor
- 1x Protective Face Shield
- 1x Scissors
- 2x Sterile Wipes
- 1x Pair of Gloves
- 2x Gauze Swabs



# Smarty Saver Wall Mount Bracket Stainless Steel

morethansafety

7011733

Wall bracket designed to hold Smarty Saver models, allowing for quick and easy access to the defibrillator.



First Aid



# Smarty Saver Normal Configuration Fully Automatic Dibrillator

7011734

Automatic Smarty Saver Defibrillator. This defibrillator automatically delivers shocks, making operation easier for the user.

The Fully Automatic model will, if a shockable rhythm is detected, warn the user of the imminent shock delivery and after 5 seconds the de-fibrillating shock will be released automatically; the CPR phase will follow.

It delivers one or more de-fibrillating shocks on adult or paediatric patients affected by ventricular fibrillation or ventricular tachycardia, using a thorax impedance-compensated, biphasic truncated exponential discharge (BTE).

## Features & Benefits:

- Affordable and easy to use
- Reliable and durable
- Dustproof and waterproof resistance IP rate
- Easily operated by anyone in the medical field and non-medical field too (e.g. public or private places)



CPR

# Leak Diverter Kit

morethansafety

4300874

## Overview:

Leaking roofs can damage valuable stock and equipment, not to mention the inconvenience of moving people and goods out of the way.

Leak Diverter deals with nuisance roof and ceiling leaks without disruption to the workplace until a permanent repair can be made. The device hangs from the roof directly under drips and leaks and diverts water to a convenient collection point. The floor beneath stays dry, the risk of slips and falls is reduced whilst damage to goods and machinery is minimised.

Adjustable hanging straps make levelling and positioning easy. Standard UK Hozelock fittings ensure water is safely channelled into the Leak Diverter reservoir drum (included in complete kit or available separately). Leak Diverter is available in four sizes in two colours, with separate accessories or as complete kit.



## QHSE Approved Multi Purpose Spill Kit 240l

4300875

Packed with fast-acting sorbents to clean-up spills quickly and efficiently. 240l capacity.

### General Purpose:

Coolant ~ Antifreeze ~ Oil ~ Water ~ Weak chemicals ~ Solvents

### Kit Content:

- 12x Absorbent Socks (8cm x 3m)
- 100x Absorbent Pads
- 4x Disposal bag & tie
- 1x Instruction and contents sheet
- 1x Medium sized wheelie bin (240l)



## Drain Protection Kit

**4100143**

Preventing spills and leaks from entering drainage systems is the best way to prevent environmental pollution.

Neoprene Drain Cover (ADR10)  
1kg Tub Plugging Granules  
Weatherproof Holdall  
(wall mountable)

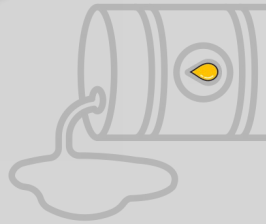

## QHSE Approved Oil & Fuel Only Spill Kit 240l

**4300876**

Packed with fast-acting sorbents to clean-up spills quickly and efficiently. 240l Capacity.

General Purpose:

Oil & Fuel ~ Hydraulic oil ~ Engine oil ~ Lubricating oil ~ Solvents ~ Will not absorb water

### Content:

- 12x Absorbent Socks (8cm x 3m)
- 100x Absorbent Pads
- 4x Disposal bag & tie
- Instruction and contents sheet
- Medium wheelie bin (240l)

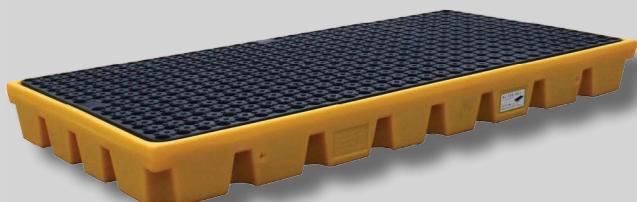

Spill Response Type ~ Bunded Workflow  
Applications ~ Drum  
Max Load ~ 1000kg  
Absorption Capacity ~ 120L

## Drum Workflow for 2x 205l Drums

**4100199**

- For storage of drums or numerous smaller containers
- Removable grid deck for easy cleaning
- Ideal for use in drum stores to provide effective secondary containment





# CBRE 8mm Fire Door Gap Gauge Kit

morethansafety

6302301

## Kit Content:

6302000 ~ Fire Door Gap Gauge Pouch  
6302277 ~ CBRE Fire Door Gap Gauge  
6302001 ~ Fire Door Check Cards



# Water Fire Extinguisher 6L

6300135

The Firechief XTR 6L Water Extinguisher is widely recognised and trusted by re-sellers and end users alike. Designed, developed and tested in the UK for use on A-class fires, this product carries the well-known Kitemark, LPCB and MED certification achieving superior results in tests.

## Features & Benefits:

- 5 year guarantee
- Designed, developed and tested in UK
- Squeeze grip operation
- Corrosion resistant finish
- Approved to BS EN3
- Supplied with J bracket
- FXW6 Approved to 35kV dielectric test
- Internal polyethylene lining
- Comes with water spray



# COSHH Floor Cupboard

morethansafety

6210178

## Features & Benefits:

- QMP's range of COSHH cupboards help users to comply with the control of hazardous substances as demanded by the COSHH regulations when in the workplace
- No snag' handles with 2-point locking
- Adjustable spill-retaining galvanised shelves for superior spill management with a UDL of 70KG
- Reaction to Fire Classification EN 13501-1
- Warning stickers supplied as standard
- Fully welded all steel structure with full length heavy duty hinges with concealed fixings to prevent forced entry
- Powder coated graphite grey with Germ Guard Active Technology paint
- Floor chests have a welded integrated sump, angled lid to discourage article placement and a hasp and staple lock - padlock not supplied
- Colour: Grey



900 x 900 x 460mm

# Hazardous Floor Cupboard

6210179

## Features & Benefits:

- QMP's range of COSHH cupboards help users to comply with the control of hazardous substances as demanded by the COSHH regulations when in the workplace
- Adjustable spill-retaining galvanised shelves for superior spill management with a UDL of 70KG
- Integral liquid-tight sump encourages the correct handling of spills through the use of absorbents
- Stands raise cupboards by 543mm with an adjustable foot for uneven surfaces
- Powder coated yellow with Germ Guard Active Technology paint
- Hazardous Cupboards come complete with a selection of hazardous warning stickers
- Reaction to Fire Classification EN 13501-1
- Colour: Yellow



900 x 900 x 460mm

# Flammable Liquid Storage Cupboard

morethansafety

6210171

## Features & Benefits:

- Reaction to Fire Classification EN 13501-1
- Warning stickers supplied as standard
- Adjustable spill retaining shelves for superior spill management
- Cupboard shelves have a UDL of 50KG
- Integral liquid-tight sump encourages the correct handling of spills through the use of absorbent cleaning materials
- Cupboard stands are available which raise cupboards by 543mm with an adjustable foot for uneven surfaces
- Powder-coated red with Germ Guard Active Technology paint
- Floor chests have a welded integrated sump, angled lid to discourage article placement and a hasp and staple lock - (padlock not supplied)
- Colour: Red



900 x 900 x 460mm

# Safegate 3 Gate Barrier

6021148

## Features & Benefits:

- Ideal for ground works, and protecting pedestrianised areas
- High density Polyethylene
- Prevent access to open manholes, drain, areas of wet flooring, trip hazards and spillages
- Compact design makes it ideal for use in workshops and even supermarkets
- One of the fastest barriers to deploy
- All packages are supplied with chapter 8 reflective strips and all the necessary clips to use the gates
- Conforms: BS 8442:2015, Chapter 8, The Red Book, TSRGD, BS7818 Specification for pedestrian restraint systems, Chapter 8 & BSEN13422, The Red Book 2013, Chapter 8
- Colour: Yellow



H 1000mm x Extended Length 2250mm Collapsed Length 750mm

# Portagate 3 Gate Compact Barrier

morethansafety

6021123

Portagate Compact Barrier Gate System  
The Portagate is a blow moulded high density polyethylene barrier, supplied as a 3 or 4 gate system. Light and compact, the Portagate is designed to meet communications industry requirements and enables increased quantities per vehicle.

## Features & Benefits:

- Configurations - Adjoining clips allow multi-positioning configurations to be formed such as a triangle, a square or a single line
- Firm hold - By sliding the top hinge clip down panels can be locked securely into formations
- Added stability - Designed to accept anti-trip feet for increase stability
- Temporary signage - Recesses are included for toggle mounted courtesy signs to enable the system to be fully closed with the signs still attached
- Reflective panels - Class R1 reflective panels which are 20% more reflective than standard lower grade reflective material conforming to BS 8442
- Stackable - Can be stacked in any 180° orientation to a height of 20 units for 4 gate systems and 25 for 3 gate systems
- Colour: Red



Barrier Gates: 3  
Material: HDPE  
EN Standards: BS 8442



# ID Card

5972071

## Features & Benefits:

CBRE Photo ID Card.

Size: 2.12" x 3.38"

Thickness: 30mil

Please note: All mandatory fields must be complete to add this to your order. Only add 1 card at a time to an order to ensure details are correct

Assign To

Employee ID Number \*

Employee Name \*

Job Title \*

Contract \*

Expiry Date \*

Photograph \*

No file chosen

Compatible file extensions to upload: jpg



### THIS CARD MUST BE CARRIED AT ALL TIMES

This card is the property of CBRE and must be returned on termination of your employment.

The card must be carried on your person at all times or worn when required.

Report the loss of the card immediately to the HR Department on 020 7871 9100

# Safety Signs



**Fire door  
keep  
shut**

# QHSE 5 C's Notice Board

9270005

Orientation: Landscape

Design printed onto 100 micron white gloss self-adhesive vinyl, laminated with dry wipe film, and applied to 5mm PVC white foam board and mounted onto 10mm black PVC foam.

Applied to board:  
Monthly magnetic calendar square and 3 x blank magnetic parts of key.

## Supplied with:

- 6 of each red, blue and green magnetic squares
- 6 x A4 transparent document holders (sticker for wording applied)
- Self tapping screws for use with document holders

**Notes:** Artwork not to size. Please allow 10 working days for production. Items may vary.

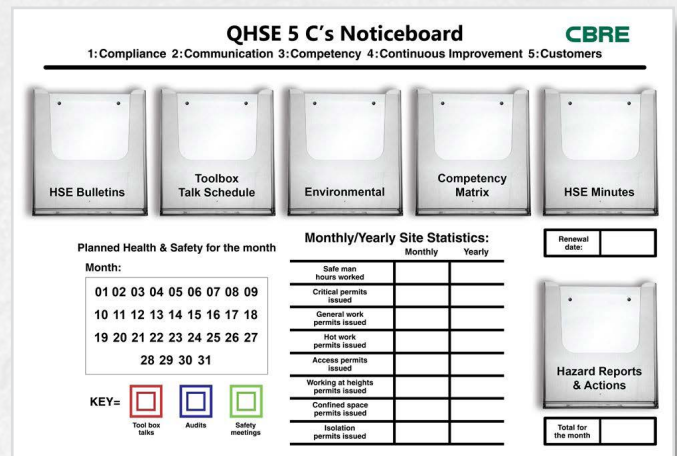

Size: 1350 x 925mm

# Weekly Work Planner Board

9270003

Orientation: Landscape

Design printed onto 100 micron white gloss self-adhesive vinyl, laminated with dry wipe film, and applied to 5mm PVC white foam board.

**Notes:** Artwork not to size. Please allow 7 working days for production. Items may vary.

CBRE Weekly Work Planner

Day	Company	Building(s)	Work Description	MSRA Yes/No	Permit Number	CBRE Number	Company Contact	Monitoring Engineer Email	Completion
Monday			Call out						
Tuesday			Call out						
Wednesday			Call out						
Thursday			Call out						
Friday			Call out						
Saturday			Call out						
Sunday			Call out						

Size: 1500 x 1000mm





# Project Site Safety Banner

morethansafety

9300009

Orientation: N/A

Material: Supported front-lit 450gms White PVC

Finishing: The banner will include eyelets, and the following sleeve supplied only.

## Supplied with:

- 9x A4 portrait sleeves
- 1x A3 landscape sleeve
- 1x Health & Safety Law Poster 420 x 595mm (Also available as a PVC Board 9270011 wording applied)
- Self tapping screws for use with document holders

**Notes:** Artwork not to size. Please allow 5 working days for production. Items may vary.

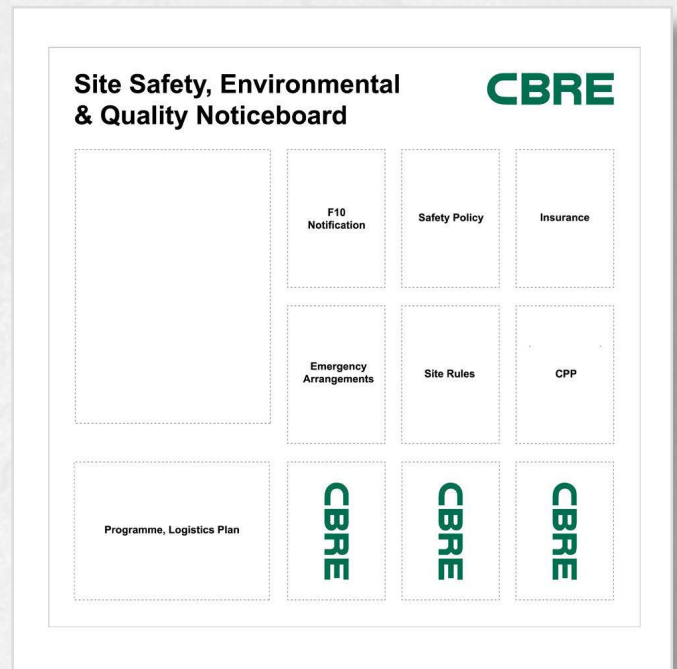

Size: 1275 x 1250mm

# Contractor Daily Attendance Board

9270001

Orientation: Landscape

Design printed onto 100 micron white gloss self-adhesive vinyl, laminated with dry wipe film, and applied to 5mm PVC white foam board.

**Notes:** Artwork not to size. Please allow 7 working days for production.

CBRE		Contractor Daily Attendance Board						Date:	
Time In	Contractor	Description of Works	Location of Works	Permit No.	CEWA No.	Dynamic RA Engineer	Monitoring Engineer	Time Out	
Approved Access Permit and Contractor RAMS				Duty Shift Team Comments					

Size: 1200 x 900mm



# Project Site Safety Banner

9100102

Health & Safety Law Poster Laminated Paper  
420 x 595mm



# Stack Accident Book

9100112

Accident Book Books 0

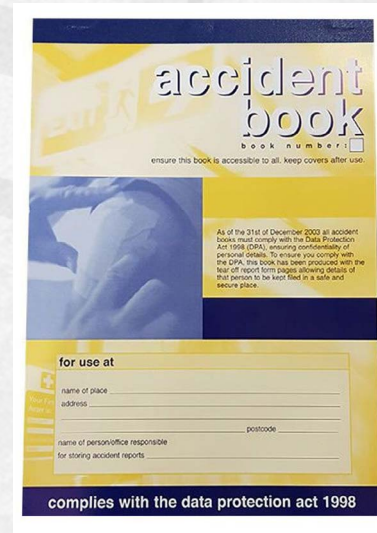

# Fire Log Book

9201867

Fire Log Book Books 0

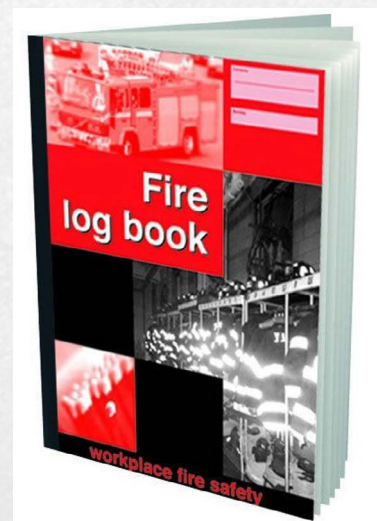

## First Aid Centre



**9202207**

800 x 700mm

First Aid Centre C/W Accessories 5mm Foam PVC



Size: 800 x 700mm

## Fire Action Centre



**9202099**

800mmx700mm

First Aid Centre C/W Accessories 5mm Foam PVC



Size: 800 x 700mm

## Fire Assembly Point Self Adhesive

**9250751**

Fire Assembly Point Self Adhesive Vinyl  
Size: 600 x 400 mm



## Fire Assembly Point Rigid

**9204461**

Fire Assembly Point 1mm Rigid Plastic  
Size: 600 x 400 mm



## Fire Exit Up Self Adhesive

**9250759**

Fire Exit Arrow Up Self Adhesive Vinyl  
Size: 600 x 200 mm

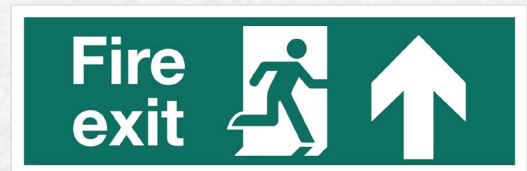

## Fire Exit Up Rigid

**9204358**

Fire Exit Arrow Up 1mm Rigid Plastic  
Size: 600 x 200mm

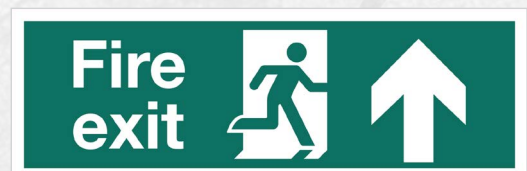



## Fire Door Keep Shut Self Adhesive

**9250372**

Fire Door Keep Shut Self Adhesive Vinyl  
Size: 100 x 150mm



## No Smoking Self Adhesive

**9204299**

No Smoking Self Adhesive Vinyl  
Size: 100 x 150mm



## No Smoking Rigid

**9204298**

No Smoking 1mm Rigid Plastic  
Size: 100 x 150mm

# Tools





## 5601504K

The electrical walkaround toolkit has the essential tools required for an electrical engineer whilst being light enough to carry on your person.

### This kit contains 20 items including:

- VDE screwdrivers & pliers
- Pickup and go tool pouch
- The approved LV isolation kit
- Fire door gap gauge kit



# Multi Skilled Engineer Toolkit

more**thansafety**

5601523

The Multi skilled engineer toolkit is ideal for multi disciplined engineers, containing all of the tools from both the full electrical & mechanical toolkits.

## This kit contains 62 items including:

- Compact Drill Driver 10.8 Volt 2 x 2.0Ah Li-Ion
- Socket set
- VDE screwdrivers & pliers
- 20l toolcase
- The approved LV isolation kit
- Loopcheck socket tester
- Combination drilling set
- Fire door gap gauge kit



# Electrical Engineer Toolkit

morethansafety

5601502B

The complete electrical toolkit contains all the tools required.

## This kit contains 42 items including:

- Compact Drill Driver 10.8 Volt  
2 x 2.0Ah Li-Ion
- Socket set
- VDE screwdrivers & pliers
- Hard bottom bag
- The approved LV isolation kit
- Loopcheck socket tester
- Fire door gap gauge kit



# Mechanical Engineer Toolkit

more**th**ansafety

**5601503B**

The mechanical toolkit contains all the tools required to complete any job.

**This kit contains 43 items including:**

- Socket set
- VDE screwdrivers & pliers
- Hard bottom bag
- Combination spanner set
- Ergo insulated screw drivers
- Fire door gap gauge kit







# Mechanical Engineer Toolkit

morethansafety

5601503S

The mechanical toolkit contains all the tools required to complete any job.

## This kit contains 45 items including:

- Socket set
- VDE screwdrivers & pliers
- Hard bottom bag
- Combination spanner set
- Pro combination drilling set
- Fire door gap gauge kit

**STANLEY**







# Multi Skilled Engineer Toolkit

morethansafety

5601425

The Multi skilled engineer toolkit is ideal for multi disciplined engineers, containing all of the tools from both the full electrical & mechanical toolkits.

## This kit contains 60 items including:

- 12 volt combi drill
- Socket set
- VDE screwdrivers & pliers
- 20l toolcase
- The approved LV isolation kit
- Loopcheck socket tester
- Combination spanner set
- Bosch GMS120
- Fire door gap gauge kit



# Electrical Lite Engineer Toolkit

morethansafety

5601416

The electrical lite toolkit is a reduced version of the full electrical toolkit but with still the tools required to complete most day to day jobs.

## This kit contains 32 items including :

- Socket set
- VDE screwdrivers & pliers
- Pickup and go tool pouch
- The approved LV isolation kit
- Fire door gap gauge kit



# Electrical Walkaround Toolkit

morethansafety

5601417

The electrical walkaround toolkit has the essential tools required for an electrical engineer whilst being light enough to carry on your person.

## This kit contains 20 items including:

- VDE screwdrivers & pliers
- Pickup and go tool pouch
- The approved LV isolation kit
- Fire door gap gauge kit



# Mechanical Engineer Toolkit

more**than**safety

5601418

The mechanical toolkit contains all the tools required to complete any job.

## This kit contains 45 items including:

- Socket set
- VDE screwdrivers & pliers
- 20l toolcase
- Combination spanner set
- Pound Thru PZ screw drivers
- Fire door gap gauge kit



# Fabric Engineer Toolkit

more**than**safety

5601194

The Fabric toolkit is ideal for decorators, plasterers and handy persons.

## This kit contains 43 items including:

- Mallets and hammers
- Chisel set
- Paintbrush and roller set
- Glass and tile suction lifters
- 20l toolcase
- Fire door gap gauge kit





# HVAC Engineer Toolkit

morethansafety

5601420

The HVAC (Refrigeration) toolkit is ideal for all heating and air conditioning servicing needs.

## This kit contains 42 items including:

- Wet and dry vacuum cleaner
- Recovery unit and vacuum pump
- 20 volt combi drill
- Digital manifold
- Set of aluminum pipe wrenchers
- 80l toolchest
- Fire door gap gauge kit









# HVAC R32 Engineer Toolkit

morethansafety

5601421

The HVAC (Refridgeration) toolkit is exactly the same as the standard HVAC toolkit except the recovery unit is suitable for R32 gasses.

## This kit contains 41 items including:

- Wet and dry vacuum cleaner
- Recovery unit and vacuum pump
- 20 volt combi drill
- Digital manifold
- Set of aluminum pipe wrenches
- 80l toolchest
- Fire door gap gauge kit





# 8100SB VDE Socket Set 3/8" Drive

morethansafety

59073775



Incredibly compact set arrangement for a lot of tools in a small space.

## Features & Benefits:

- Provides safe and secure storage
- Individually tested ratchet, sockets and extensions as per IEC 60900 at 10,000V for safe working at the approved voltage of 1,000V
- 8007 B VDE 3/8" Ratchet
- 3/8" Drive 8790 B VDE Sockets: 6, 7, 8, 9, 10, 11, 12, 13, 14, 15, 16, 17, 18 & 19mm
- VDE Extension bars: 91 & 160mm Long
- Textile box with very high robustness and durability
- Smooth turning mechanism for secure hold and easy removal of VDE sockets
- Low weight and volume for easier mobility



# Kraftform Kompakt W2 Maintenance Kit 35 Piece

59073784

Compact tool set with the 35 most important screw driving tools for maintenance work both indoors as well as outdoors.

## Features & Benefits:

- Includes VDE holder with 12 VDE blades
- 1 Joker double open-end wrench with holding function limit stop, small return angle and extremely gripping teeth
- The incredibly fast 1/4" Zyklop Speed ratchet and accessories
- 8 manual and power tool sockets, sizes 5.5-13, 1 universal bit holder; 7 bits in a length of 25mm
- 1 screw gripper for firmly holding screws
- 1 voltage tester 247
- Textile box: Robust and durable
- VDE Extension bars: 91 & 160mm Long



# Wera Kraftform Micro ESD Screwdriver Set (25 Piece)

morethansafety

59073793

## Features & Benefits:

Electrostatically secured Wera Micro screwdriver 25-piece set. The included screw profiles are especially suitable for the use on mobile phones and tablets.

Safe protection against electrostatic energy and associated damage.

By supporting the hand on the rotating cap, and by the fast rotating zone below the rotating cap, lightning fast turning is possible.

The power zone with integrated soft zones ensures the transmission of high tightening and loosening moments.

Precision zone for correct rotation angles whilst adjusting.

The Black Point tip provides fitting accuracy and optimum corrosion protection. Take it easy tool finder with size stamping and colour coding by profile to find the required tool quickly and easily.

Storage and transport in a robust textile pouch, so the tool is well protected and always close at hand.

Time-consuming hand switching is eliminated.

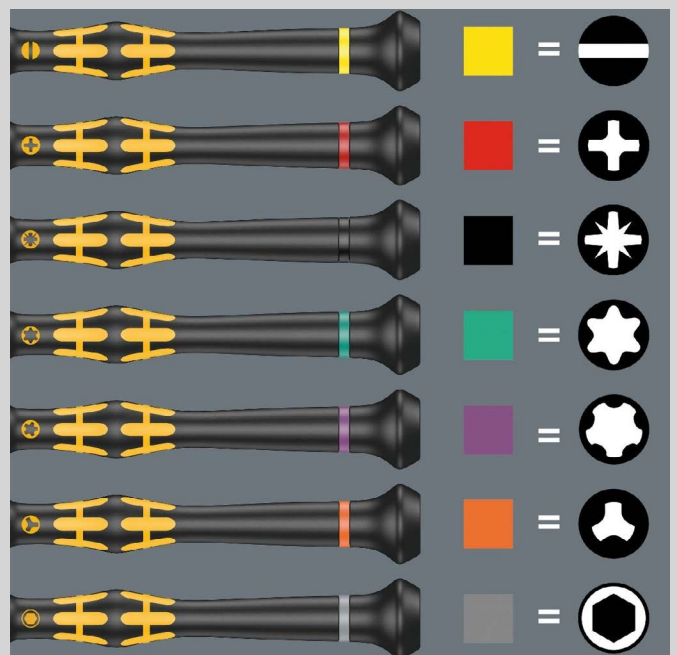
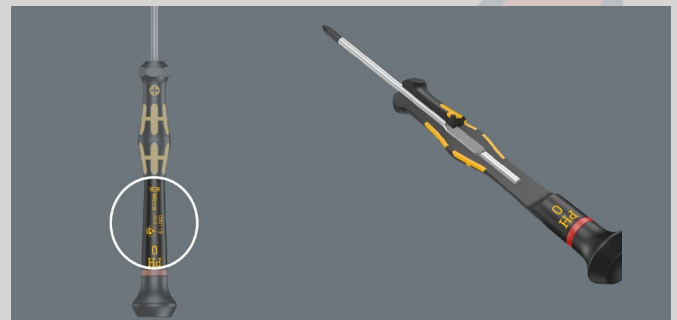

# Stainless Torsion Bit Set (30 Piece)

morethansafety

59073616

## Features & Benefits:

Bit-Check that can be positioned upright with high quality bits out of stainless steel.

Wera stainless tools are manufactured out of stainless steel, thus preventing the formation of unsightly extraneous rust. 29 Wera stainless bits.

1 stainless Rapidaptor quick-release holder. The multi-component Bit-Check is convincing on account of its low weight and the maximum possible degree of compactness.

In this respect, the soft material in the lower section of the Bit-Check ensures that the bits are securely held whilst being simple to remove at the same time.

The profile and size of the bits are easy to recognise thanks to the Wera "Take it easy" Tool Finder with its colour coding and clearly visible imprint.

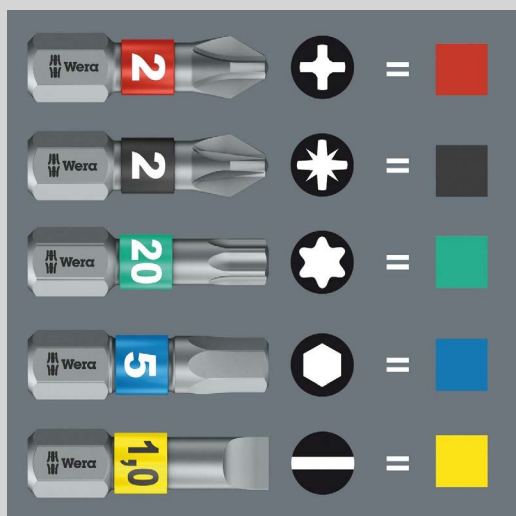
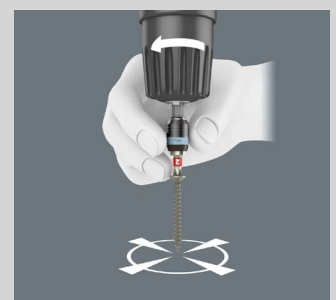

# TSTAK Twin Kit With 2x 4.0Ah Batteries

morethansafety

5100097

## Features & Benefits:

The DEWALT DCK266M2T TSTAK™ Twin Kit, contains the following:

1 x 18V DCD796 XR Brushless Combi Drill which has an ultra-compact, lightweight design.

Chuck: 13mm Keyless

No Load Speed: 0-550/0-2,000/min

Impact Rate: 0-9,350/34,000/bpm

Torque: 27/70Nm, 15 Settings

Capacity: Masonry/Steel 13mm, Wood 40mm

1 x 18V DCF887 XR Brushless Impact Driver is equipped with application control. This is achieved through 3 motor speeds and torque settings.

Bit Holder: 6.35mm (1/4in)

No Load Speed: 0-1,000/0-2,800/0-3,250/min

Impact Rate: 0-1,800/0-2,900/0-3,800/bpm

Max. Torque: 26/80/205Nm

Weight: 1.56kg

Also supplied with: 1 x 10.8-18V DCB115 Multi-Voltage XR Charger, 2 x 18V 4.0Ah Batteries and 1 x TSTAK™ Case.



## Pressure Washer 1400W 105Bar

morethansafety

**5109914**

Perfect for cleaning patios, cars, caravans or worksites. This simple to use washer features a carry handle and large wheels, which make it easier to manoeuvre. The total stop device is designed to save water, prolonging the life of both the pump and the motor.

### Specification:

- Wattage: 1600
- Working pressure (+/-10%): 1305psi (90bar)
- Max pressure (+/-10%): 1958psi (135bar)
- Working flow (+/-10%): 5.5l/min
- Max flow (+/-10%): 7.1l/min
- Hose length: 5m
- Cable length: 5m
- Weight: 8kg



## Henry Type 230V Vacuum Cleaner NRV200

**5120111**

The Henry vacuum with its one-piece polypropylene and struct foam tanks are long-wearing, dent and corrosion proof and light in weight.

### Specification:

- Powerful motors
- Designed with wide bases to prevent tipping
- Unique rewind and storage system
- Super-efficient filtration
- Quiet operation
- Friendly smiles are standard equipment
- Can be used with or without bags

